

Offering #1: Tax Cards

Address: TBD Piney Forest Rd., TBD Lansdale St., Danville, VA
24540

***Parcel ID 70250, 70251, 51231, 57335, 50968;
Consisting of +/- 3.87 acres and improvements***



VAAuctionPro.com



**Blue Ridge Land
& Auction Co., Inc**

Matt Gallimore, Broker/Auctioneer



PINEY FOREST RD

Summary

Parcel ID: 50968
Address: PINEY FOREST RD

Owner Information
Owner Name: MARY & K D'S DINER INC
Owner Address: 1203 PINEY FOREST RD
Mail-To: MARY & K D'S DINER INC
Mailing Address: 1203 PINEY FOREST RD, DANVILLE, VA 24540

Land Information
Flood Zones: N/A
Enterprise Zones: N/A
Historic Districts: N/A

Elementary School District: EA Gibson

Middle School District: O.T. Bonner

Value Information
Land Value: \$117,800
Land Use Value: N/A
Improvement: N/A
Total: \$117,800

Additional Information
State Code: 4091 Vac Com Buildable - 1
Land Use: Commercial
Tax Map: 1808011000034000
Approx. Acres: 1.071
Legal Description: 100.3 FT NO 20 PINEY FOREST RD
Zone: HRC Highway Retail Comm
Notes: Avg Lot: 95.0 x 570.0 DB 22-846: Affidavit with Merger from SCC attached, effective 3/1/18 & 30 lists. DB 06-617: 5 lists. DB 04-3657: William died 6/14/02, by sur to other 2 owners.



Land

**Land area is based on information available, therefore acreage and/or square footage may be approximated.*

Land Code: Comm FF (1000)	Rate: \$1,000
Acres/Units: 1.24	Adj. Rate: \$1,240
Sq. Ft.: 54014.4	Base Value: \$117,800
Front: N/A	Adj. Amount: N/A
Effective Front: 95	Value: \$117,800
Depth: 570	



Transfers

Deed:	Page:	Sale Date:	Sale Price:	Previous Owner:	Owner:
D 22	846	02/17/2022	N/A	DODSON GROUP INC	MARY & K D'S DINER INC
D 06	617	02/08/2006	N/A	FARLOW JR JAMES M	DODSON GROUP INC
D 04	3657	07/15/2004	\$230,000	JONES WILLIAM L	FARLOW JAMES M JR & MARY ELENE
D 95	1814	05/15/1995	N/A	N/A	N/A



Assessments

Year:	Land:	Use:	Improvements:	Total:
2023	\$117,800	N/A	N/A	\$117,800
2022	\$117,800	N/A	N/A	\$117,800
2021	\$117,800	N/A	N/A	\$117,800
2020	\$117,800	N/A	N/A	\$117,800
2019	\$117,800	N/A	N/A	\$117,800
2018	\$117,800	N/A	N/A	\$117,800
2017	\$117,800	N/A	N/A	\$117,800
2016	\$117,800	N/A	N/A	\$117,800
2015	\$117,800	N/A	N/A	\$117,800
2014	\$117,800	N/A	N/A	\$117,800
2013	\$117,800	N/A	N/A	\$117,800
2012	\$117,800	N/A	N/A	\$117,800
2011	\$117,800	N/A	N/A	\$117,800
2010	\$117,800	N/A	N/A	\$117,800
2009	\$117,800	N/A	N/A	\$117,800
2008	\$117,800	N/A	N/A	\$117,800
2007	\$117,800	N/A	N/A	\$117,800
2006	\$117,800	N/A	N/A	\$117,800
2005	\$17,700	N/A	N/A	\$17,700
2004	\$17,700	N/A	\$30,700	\$48,400
2003	\$17,700	N/A	\$29,100	\$46,800
2002	\$17,700	N/A	\$29,100	\$46,800
2001	\$11,800	N/A	\$27,400	\$39,200
2000	\$11,800	N/A	\$27,400	\$39,200





PINEY FOREST RD

Summary

Parcel ID: 51231
Address: PINEY FOREST RD

Owner Information

Owner Name: MARY & K D'S DINER INC
Owner Address: 1203 PINEY FOREST RD
Mail-To: MARY & K D'S DINER INC
Mailing Address: 1203 PINEY FOREST RD, DANVILLE, VA 24540

Land Information

Flood Zones: N/A
Enterprise Zones: N/A
Historic Districts: N/A
Elementary School District: EA Gibson
Middle School District: O.T. Bonner

Value Information

Land Value: \$73,800
Land Use Value: N/A
Improvement: N/A
Total: \$73,800

Additional Information

State Code: 4091 Vac Com Buildable - 1
Land Use: Commercial
Tax Map: 1808011000036000
Approx. Acres: 0.5555
Legal Description: 61.3 FT PT NO 19 PINEY FOREST RD
Zone: HRC Highway Retail Comm
Notes: Avg Lot: 61.0 X 400.0 DB 22-846: Affidavit with Merger from SCC attached, effective 3/1/18 & 30 lists.



Land

**Land area is based on information available, therefore acreage and/or square footage may be approximated.*

Land Code: Comm FF (1000)	Rate: \$1,000
Acres/Units: 0.56	Adj. Rate: \$1,210
Sq. Ft.: 24393.6	Base Value: \$73,810
Front: N/A	Adj. Amount: \$-10
Effective Front: 61	Value: \$73,800
Depth: 400	



Transfers

Deed:	Page:	Sale Date:	Sale Price:	Previous Owner:	Owner:
D 22	846	02/17/2022	N/A	DODSON GROUP INC	MARY & K D'S DINER INC
D 06	618	02/08/2006	N/A	FARLOW JR JAMES M	DODSON GROUP INC
D 05	3368	07/12/2005	\$125,000	THOMPSON JEFFREY GALE	FARLOW JR JAMES M
D 02	6563	11/19/2002	N/A	THOMPSON JEFFREY GALE	THOMPSON JEFFREY GALE & PAIGE S
D 00	5666	12/15/2000	\$100,000	HARRIS ANGELA D	THOMPSON JEFFREY GALE
D 00	2305	05/15/2000	N/A	HARRIS EDMUND J	HARRIS ANGELA D
D 916	105	04/29/1994	\$65,000	N/A	HARRIS EDMUND J & ANGELA D



Assessments

Year:	Land:	Use:	Improvements:	Total:
2023	\$73,800	N/A	N/A	\$73,800
2022	\$73,800	N/A	N/A	\$73,800
2021	\$73,800	N/A	N/A	\$73,800
2020	\$73,800	N/A	N/A	\$73,800
2019	\$73,800	N/A	\$35,800	\$109,600
2018	\$73,800	N/A	\$35,800	\$109,600
2017	\$73,800	N/A	\$36,000	\$109,800
2016	\$73,800	N/A	\$36,000	\$109,800
2015	\$73,800	N/A	\$36,300	\$110,100
2014	\$73,800	N/A	\$36,300	\$110,100
2013	\$73,800	N/A	\$36,900	\$110,700
2012	\$73,800	N/A	\$36,900	\$110,700
2011	\$73,800	N/A	\$37,800	\$111,600
2010	\$73,800	N/A	\$37,800	\$111,600
2009	\$73,800	N/A	\$41,200	\$115,000
2008	\$73,800	N/A	\$41,200	\$115,000
2007	\$73,800	N/A	\$39,300	\$113,100
2006	\$73,800	N/A	\$39,300	\$113,100
2005	\$73,800	N/A	\$24,200	\$98,000
2004	\$73,800	N/A	\$24,200	\$98,000
2003	\$73,800	N/A	\$23,400	\$97,200
2002	\$73,800	N/A	\$23,400	\$97,200
2001	\$51,700	N/A	\$23,200	\$74,900
2000	\$51,700	N/A	\$23,200	\$74,900





PINEY FOREST RD

Summary

Parcel ID: 57335
Address: PINEY FOREST RD

Owner Information

Owner Name: MARY & K D'S DINER INC
Owner Address: 1203 PINEY FOREST RD
Mail-To: MARY & K D'S DINER INC
Mailing Address: 1203 PINEY FOREST RD, DANVILLE, VA 24540

Land Information

Flood Zones: N/A
Enterprise Zones: N/A
Historic Districts: N/A
Elementary School District: EA Gibson
Middle School District: O.T. Bonner

Value Information

Land Value: \$50,000
Land Use Value: N/A
Improvement: N/A
Total: \$50,000

Additional Information

State Code: 4091 Vac Com Buildable - 1
Land Use: Commercial
Tax Map: 1808011000035000
Approx. Acres: 0.7726
Legal Description: 40 FT PT NO 19 PINEY FOREST RD
Zone: HRC Highway Retail Comm
Notes: DB 22-846: Affidavit with Merger from SCC attached, effective 3/1/18 & 30 lists.



Land

**Land area is based on information available, therefore acreage and/or square footage may be approximated.*

Land Code: Comm FF (1000)	Rate: \$1,000
Acres/Units: 0.6	Adj. Rate: \$1,250
Sq. Ft.: 26136	Base Value: \$50,000
Front: N/A	Adj. Amount: N/A
Effective Front: 40	Value: \$50,000
Depth: 650	



Transfers

Deed:	Page:	Sale Date:	Sale Price:	Previous Owner:	Owner:
D 22	846	02/17/2022	N/A	DODSON GROUP INC	MARY & K D'S DINER INC
D 05	4492	09/07/2005	\$150,000	MARTIN MC PROPERTIES LLC	DODSON GROUP INC
D 05	2852	06/10/2005	N/A	MARTIN MC PROPERTIES LLC	MARTIN MC PROPERTIES LLC C/O SMITH CHARLES
D 02	222	01/10/2002	N/A	FIRST STATE BANK T/U/W	MARTIN MC PROPERTIES LLC
D 861	308	05/15/1991	N/A	N/A	N/A



Assessments

Year:	Land:	Use:	Improvements:	Total:
2023	\$50,000	N/A	N/A	\$50,000
2022	\$50,000	N/A	N/A	\$50,000
2021	\$50,000	N/A	N/A	\$50,000
2020	\$50,000	N/A	N/A	\$50,000
2019	\$50,000	N/A	N/A	\$50,000
2018	\$50,000	N/A	N/A	\$50,000
2017	\$50,000	N/A	N/A	\$50,000
2016	\$50,000	N/A	N/A	\$50,000
2015	\$50,000	N/A	N/A	\$50,000
2014	\$50,000	N/A	N/A	\$50,000
2013	\$50,000	N/A	N/A	\$50,000
2012	\$50,000	N/A	N/A	\$50,000
2011	\$50,000	N/A	N/A	\$50,000
2010	\$50,000	N/A	N/A	\$50,000
2009	\$50,000	N/A	N/A	\$50,000
2008	\$50,000	N/A	N/A	\$50,000
2007	\$50,000	N/A	N/A	\$50,000
2006	\$50,000	N/A	N/A	\$50,000
2005	\$5,300	N/A	N/A	\$5,300
2004	\$5,300	N/A	N/A	\$5,300
2003	\$5,300	N/A	N/A	\$5,300
2002	\$5,300	N/A	N/A	\$5,300
2001	\$2,500	N/A	N/A	\$2,500
2000	\$2,500	N/A	N/A	\$2,500





SYLVAN RD

Summary

Parcel ID: 70250
Address: SYLVAN RD

Owner Information

Owner Name: MARY & K D'S DINER INC
Owner Address: 1203 PINEY FOREST RD
Mail-To: MARY & K D'S DINER INC
Mailing Address: 1203 PINEY FOREST RD, DANVILLE, VA 24540

Land Information

Flood Zones: N/A
Enterprise Zones: N/A
Historic Districts: N/A
Elementary School District: EA Gibson
Middle School District: O.T. Bonner

Value Information

Land Value: \$500
Land Use Value: N/A
Improvement: N/A
Total: \$500

Additional Information

State Code: 1091 Vac Res Lot Buildable - 1
Land Use: Residential
Tax Map: 1807001000004000
Approx. Acres: 0.6218
Legal Description: NOS 3 & 4 & 5 SEC B (.62 AC) SYLVAN RD
Zone: OTR Old Town Residential
Notes: DB 22-846: Affidavit with Merger from SCC attached, effective 3/1/18 & 30 lists. DB 05-4492: 3 lists incl acct# 70250, 70251 & 57335. DB 00-4432: 4 lists.



Land

**Land area is based on information available, therefore acreage and/or square footage may be approximated.*

Land Code: Res Lots FV 500	Rate: \$500
Acres/Units: N/A	Adj. Rate: \$500
Sq. Ft.: N/A	Base Value: N/A
Front: N/A	Adj. Amount: N/A
Effective Front: N/A	Value: \$500
Depth: N/A	



Transfers

Deed:	Page:	Sale Date:	Sale Price:	Previous Owner:	Owner:
D 22	846	02/17/2022	N/A	DODSON GROUP INC	MARY & K D'S DINER INC
D 05	4492	09/07/2005	\$150,000	MARTIN MC PROPERTIES LLC	DODSON GROUP INC
D 00	4432	09/20/2000	N/A	MARTIN HORTENSE P	M C MARTIN PROPERTIES LLC
W 48	411	10/30/1981	N/A	N/A	N/A
DP400	278	09/01/1961	\$1,155	N/A	N/A



Assessments

Year:	Land:	Use:	Improvements:	Total:
2023	\$500	N/A	N/A	\$500
2022	\$500	N/A	N/A	\$500
2021	\$500	N/A	N/A	\$500
2020	\$500	N/A	N/A	\$500
2019	\$500	N/A	N/A	\$500
2018	\$500	N/A	N/A	\$500
2017	\$500	N/A	N/A	\$500
2016	\$500	N/A	N/A	\$500
2015	\$500	N/A	N/A	\$500
2014	\$500	N/A	N/A	\$500
2013	\$500	N/A	N/A	\$500
2012	\$500	N/A	N/A	\$500
2011	\$500	N/A	N/A	\$500
2010	\$500	N/A	N/A	\$500
2009	\$500	N/A	N/A	\$500
2008	\$500	N/A	N/A	\$500
2007	\$500	N/A	N/A	\$500
2006	\$500	N/A	N/A	\$500
2005	\$500	N/A	N/A	\$500
2004	\$500	N/A	N/A	\$500
2003	\$500	N/A	N/A	\$500
2002	\$500	N/A	N/A	\$500
2001	\$500	N/A	N/A	\$500
2000	\$500	N/A	N/A	\$500

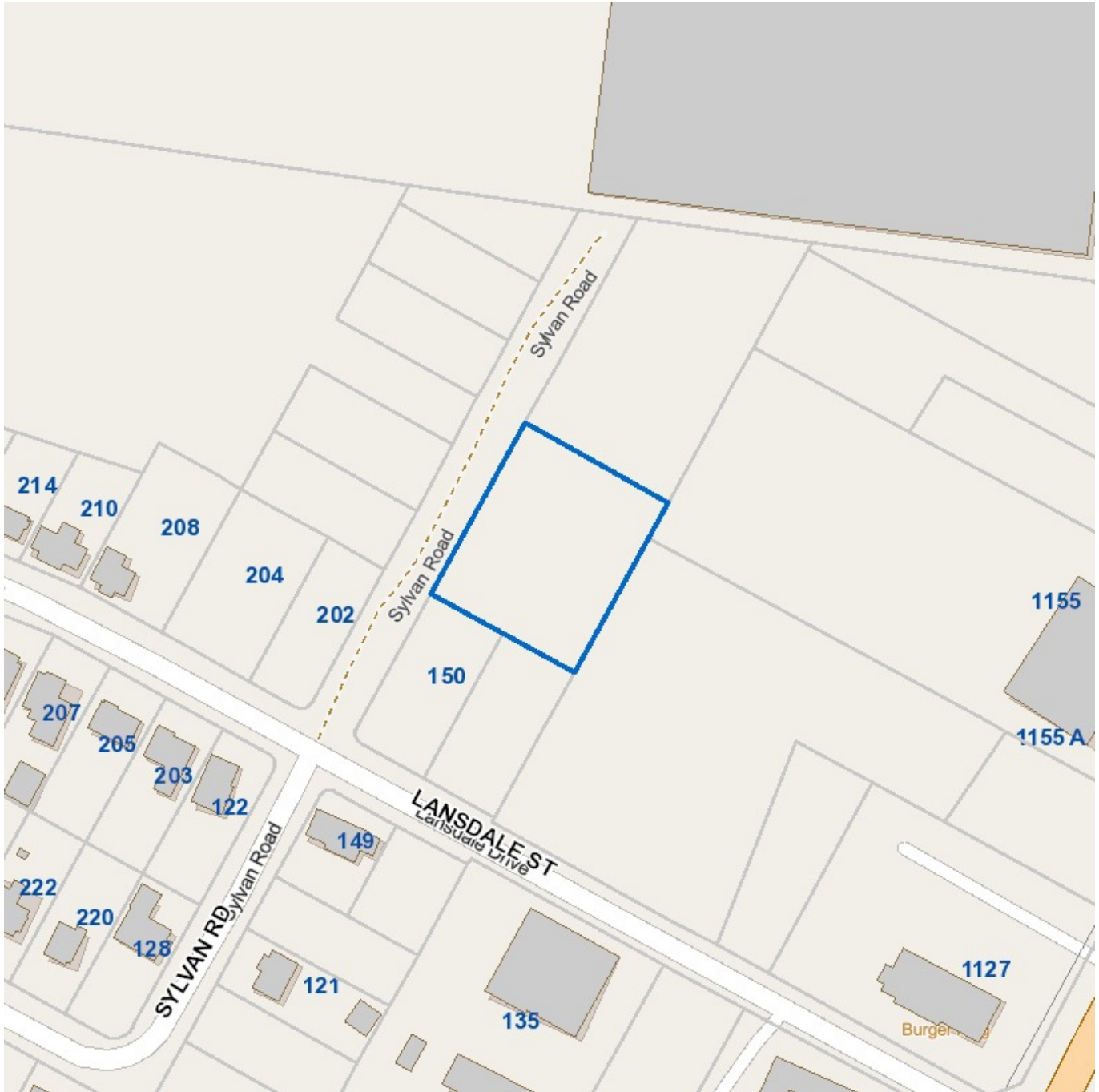



SYLVAN RD

Summary

Parcel ID: 70251
Address: SYLVAN RD

Owner Information

Owner Name: MARY & K D'S DINER INC
Owner Address: 1203 PINEY FOREST RD
Mail-To: MARY & K D'S DINER INC
Mailing Address: 1203 PINEY FOREST RD, DANVILLE, VA 24540

Land Information

Flood Zones: N/A
Enterprise Zones: N/A
Historic Districts: N/A
Elementary School District: EA Gibson
Middle School District: O.T. Bonner

Value Information

Land Value: \$500
Land Use Value: N/A
Improvement: N/A
Total: \$500

Additional Information

State Code: 1091 Vac Res Lot Buildable - 1
Land Use: Residential
Tax Map: 1807001000005000
Approx. Acres: 0.847
Legal Description: NOS 6 7 & 8 SEC B (.87 AC) SYLVAN RD
Zone: OTR Old Town Residential
Notes: DB 22-846: Affidavit with Merger from SCC attached, effective 3/1/18 & 30 lists. DB 05-4492: 3 lists incl acct# 70250, 70251 & 57335. DB 00-4432: 4 lists.



Land

**Land area is based on information available, therefore acreage and/or square footage may be approximated.*

Land Code: Res Lots FV 500	Rate: \$500
Acres/Units: N/A	Adj. Rate: \$500
Sq. Ft.: N/A	Base Value: N/A
Front: N/A	Adj. Amount: N/A
Effective Front: N/A	Value: \$500
Depth: N/A	



Transfers

Deed:	Page:	Sale Date:	Sale Price:	Previous Owner:	Owner:
D 22	846	02/17/2022	N/A	DODSON GROUP INC	MARY & K D'S DINER INC
D 05	4492	09/07/2005	\$150,000	MARTIN MC PROPERTIES LLC	DODSON GROUP INC
D 00	4432	09/20/2000	N/A	MARTIN HORTENSE P	M C MARTIN PROPERTIES LLC
W 48	411	10/30/1981	N/A	N/A	N/A
DP405	186	01/06/1961	\$1,400	N/A	N/A



Assessments

Year:	Land:	Use:	Improvements:	Total:
2023	\$500	N/A	N/A	\$500
2022	\$500	N/A	N/A	\$500
2021	\$500	N/A	N/A	\$500
2020	\$500	N/A	N/A	\$500
2019	\$500	N/A	N/A	\$500
2018	\$500	N/A	N/A	\$500
2017	\$500	N/A	N/A	\$500
2016	\$500	N/A	N/A	\$500
2015	\$500	N/A	N/A	\$500
2014	\$500	N/A	N/A	\$500
2013	\$500	N/A	N/A	\$500
2012	\$500	N/A	N/A	\$500
2011	\$500	N/A	N/A	\$500
2010	\$500	N/A	N/A	\$500
2009	\$500	N/A	N/A	\$500
2008	\$500	N/A	N/A	\$500
2007	\$500	N/A	N/A	\$500
2006	\$500	N/A	N/A	\$500
2005	\$500	N/A	N/A	\$500
2004	\$500	N/A	N/A	\$500
2003	\$500	N/A	N/A	\$500
2002	\$500	N/A	N/A	\$500
2001	\$500	N/A	N/A	\$500
2000	\$500	N/A	N/A	\$500



Offering #2: Tax Cards

Address: TBD Lansdale St., TBD Sylvan Rd., Danville, VA 24540

***Parcel ID 78290, 70246, 70229, 70230, 70231, 70228,
70227, 70226, 70225, 70224, 70245, 70266, 70265, 70256,
70255, 70254, 70253, 70252; Consisting of +/- 11.02 acres
and improvements***



VAAuctionPro.com



**Blue Ridge Land
& Auction Co., Inc**

Matt Gallimore, Broker/Auctioneer



LANSDALE ST

Summary

Parcel ID: 70224
Address: LANSDALE ST

Owner Information

Owner Name: MARY & K D'S DINER INC
Owner Address: 1203 PINEY FOREST RD
Mail-To: MARY & K D'S DINER INC
Mailing Address: 1203 PINEY FOREST RD, DANVILLE, VA 24540

Land Information

Flood Zones: N/A
Enterprise Zones: N/A
Historic Districts: N/A
Elementary School District: EA Gibson
Middle School District: O.T. Bonner

Value Information

Land Value: \$800
Land Use Value: N/A
Improvement: N/A
Total: \$800

Additional Information

State Code: 1091 Vac Res Lot Buildable - 1
Land Use: Residential
Tax Map: 1807002000019000
Approx. Acres: 0.1846
Legal Description: NO 25 SEC A LANSDALE ST
Zone: OTR Old Town Residential
Notes: DB 22-846: Affidavit with Merger from SCC attached, effective 3/1/18 & 30 lists. DB 05-5835: 17 lists.



Land

**Land area is based on information available, therefore acreage and/or square footage may be approximated.*

Land Code: Res Lots FV 800	Rate: \$800
Acres/Units: N/A	Adj. Rate: \$800
Sq. Ft.: N/A	Base Value: N/A
Front: N/A	Adj. Amount: N/A
Effective Front: N/A	Value: \$800
Depth: N/A	



Transfers

Deed:	Page:	Sale Date:	Sale Price:	Previous Owner:	Owner:
D 22	846	02/17/2022	N/A	DODSON GROUP INC	MARY & K D'S DINER INC
D 05	5835	11/18/2005	\$100,000	HOUSEMOVERS OF DANVILLE	DODSON GROUP INC
DP415	541	11/28/1961	N/A	N/A	N/A



Assessments

Year:	Land:	Use:	Improvements:	Total:
2023	\$800	N/A	N/A	\$800
2022	\$800	N/A	N/A	\$800
2021	\$800	N/A	N/A	\$800
2020	\$800	N/A	N/A	\$800
2019	\$800	N/A	N/A	\$800
2018	\$800	N/A	N/A	\$800
2017	\$800	N/A	N/A	\$800
2016	\$800	N/A	N/A	\$800
2015	\$800	N/A	N/A	\$800
2014	\$800	N/A	N/A	\$800
2013	\$800	N/A	N/A	\$800
2012	\$800	N/A	N/A	\$800
2011	\$800	N/A	N/A	\$800
2010	\$800	N/A	N/A	\$800
2009	\$800	N/A	N/A	\$800
2008	\$800	N/A	N/A	\$800
2007	\$800	N/A	N/A	\$800
2006	\$800	N/A	N/A	\$800
2005	\$800	N/A	N/A	\$800
2004	\$800	N/A	N/A	\$800
2003	\$800	N/A	N/A	\$800
2002	\$800	N/A	N/A	\$800
2001	\$800	N/A	N/A	\$800
2000	\$800	N/A	N/A	\$800

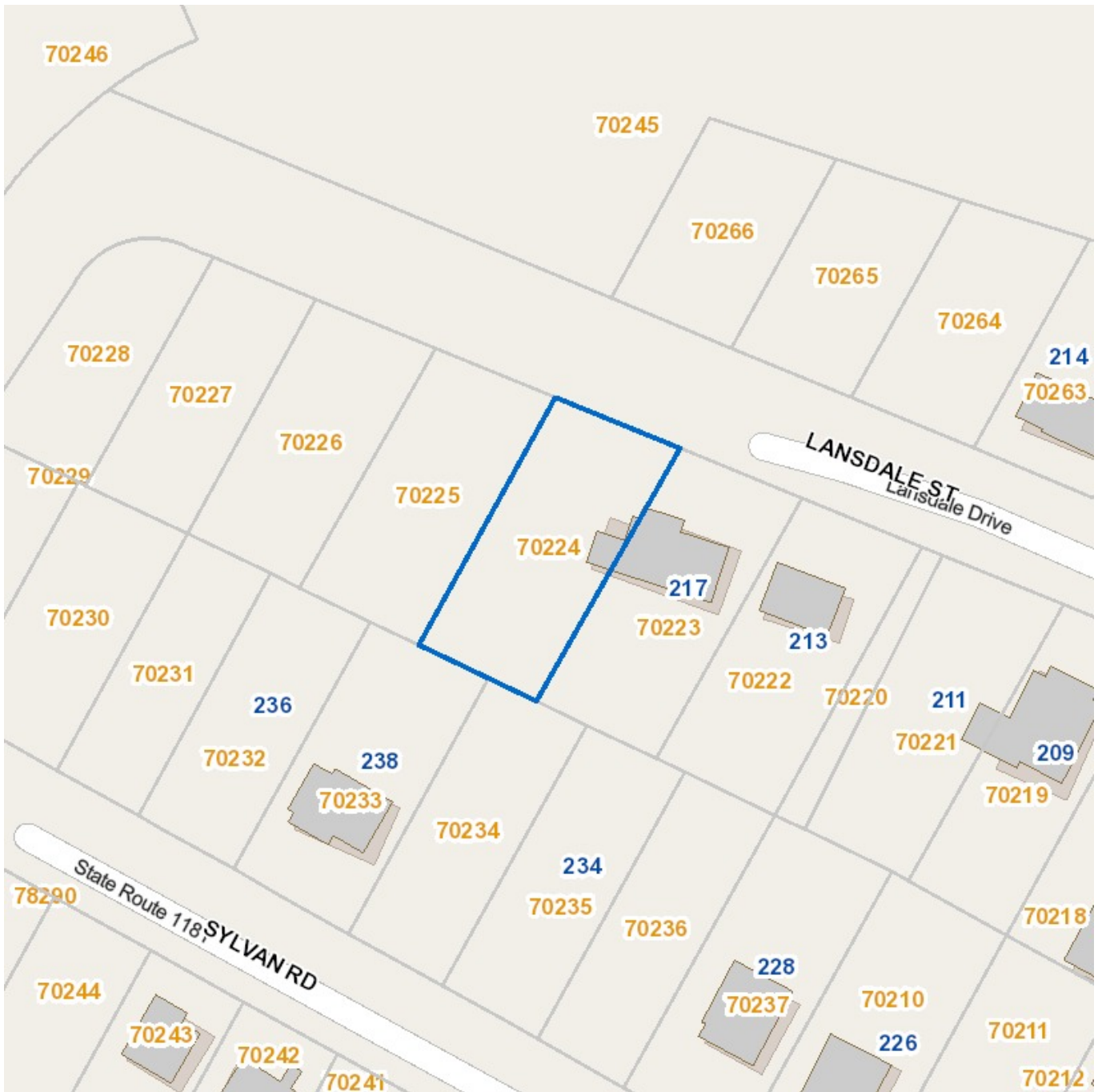



LANSDALE ST

Summary

Parcel ID: 70225
Address: LANSDALE ST

Owner Information

Owner Name: MARY & K D'S DINER INC
Owner Address: 1203 PINEY FOREST RD
Mail-To: MARY & K D'S DINER INC
Mailing Address: 1203 PINEY FOREST RD, DANVILLE, VA 24540

Land Information

Flood Zones: N/A
Enterprise Zones: N/A
Historic Districts: N/A
Elementary School District: EA Gibson
Middle School District: O.T. Bonner

Value Information

Land Value: \$500
Land Use Value: N/A
Improvement: N/A
Total: \$500

Additional Information

State Code: 1091 Vac Res Lot Buildable - 1
Land Use: Residential
Tax Map: 1807002000018000
Approx. Acres: 0.1776
Legal Description: NO 26 SEC A LANSDALE ST
Zone: OTR Old Town Residential
Notes: DB 22-846: Affidavit with Merger from SCC attached, effective 3/1/18 & 30 lists. DB 05-5835: 17 lists.



Land

**Land area is based on information available, therefore acreage and/or square footage may be approximated.*

Land Code: Res Lots FV 500	Rate: \$500
Acres/Units: N/A	Adj. Rate: \$500
Sq. Ft.: N/A	Base Value: N/A
Front: N/A	Adj. Amount: N/A
Effective Front: N/A	Value: \$500
Depth: N/A	



Transfers

Deed:	Page:	Sale Date:	Sale Price:	Previous Owner:	Owner:
D 22	846	02/17/2022	N/A	DODSON GROUP INC	MARY & K D'S DINER INC
D 05	5835	11/18/2005	\$100,000	HOUSEMOVERS OF DANVILLE	DODSON GROUP INC
DP415	541	11/28/1961	N/A	N/A	N/A



Assessments

Year:	Land:	Use:	Improvements:	Total:
2023	\$500	N/A	N/A	\$500
2022	\$500	N/A	N/A	\$500
2021	\$500	N/A	N/A	\$500
2020	\$500	N/A	N/A	\$500
2019	\$500	N/A	N/A	\$500
2018	\$500	N/A	N/A	\$500
2017	\$500	N/A	N/A	\$500
2016	\$500	N/A	N/A	\$500
2015	\$500	N/A	N/A	\$500
2014	\$500	N/A	N/A	\$500
2013	\$500	N/A	N/A	\$500
2012	\$500	N/A	N/A	\$500
2011	\$500	N/A	N/A	\$500
2010	\$500	N/A	N/A	\$500
2009	\$500	N/A	N/A	\$500
2008	\$500	N/A	N/A	\$500
2007	\$500	N/A	N/A	\$500
2006	\$500	N/A	N/A	\$500
2005	\$500	N/A	N/A	\$500
2004	\$500	N/A	N/A	\$500
2003	\$500	N/A	N/A	\$500
2002	\$500	N/A	N/A	\$500
2001	\$500	N/A	N/A	\$500
2000	\$500	N/A	N/A	\$500

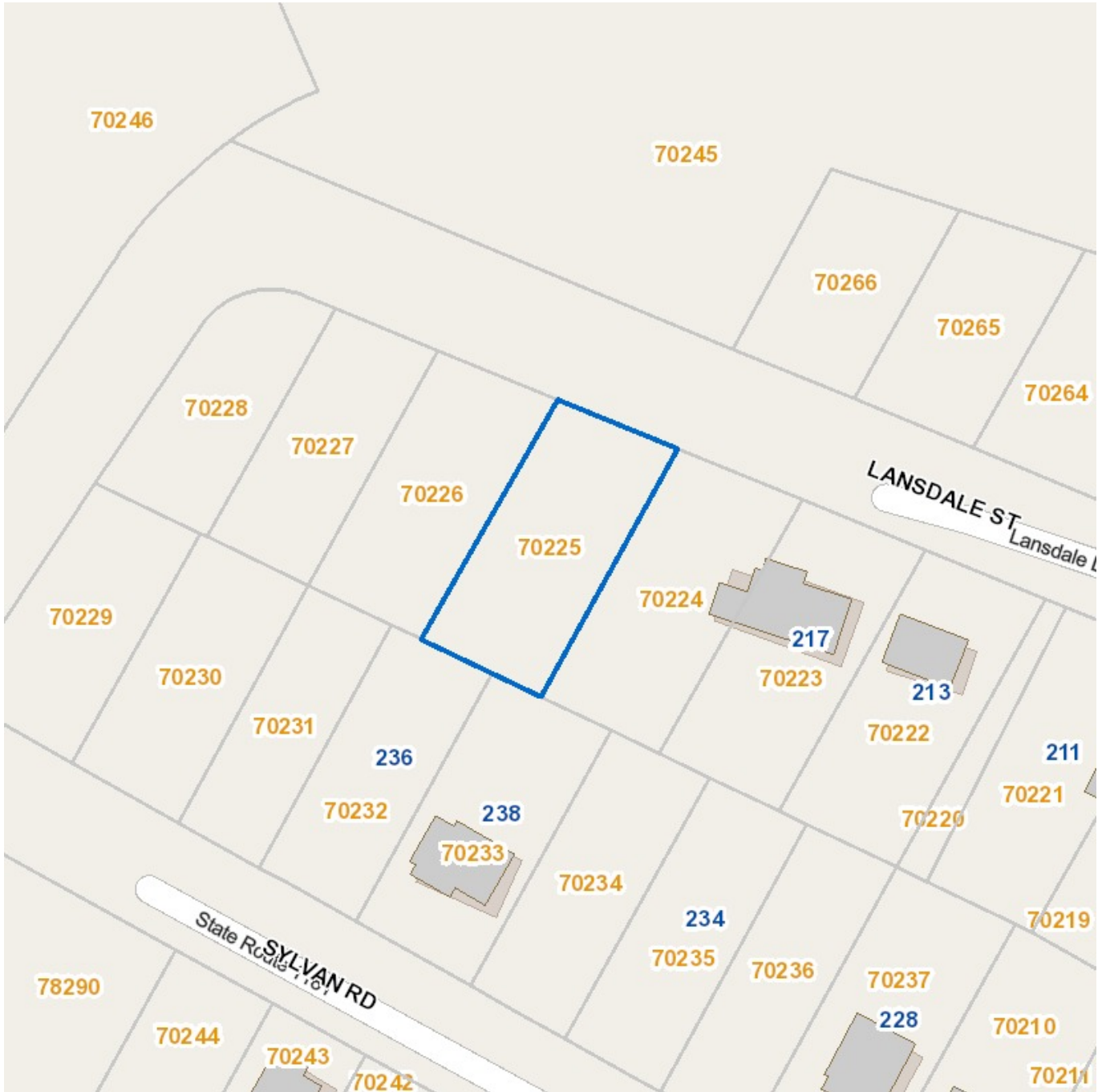



LANSDALE ST

Summary

Parcel ID: 70226
Address: LANSDALE ST

Owner Information

Owner Name: MARY & K D'S DINER INC
Owner Address: 1203 PINEY FOREST RD
Mail-To: MARY & K D'S DINER INC
Mailing Address: 1203 PINEY FOREST RD, DANVILLE, VA 24540

Land Information

Flood Zones: N/A
Enterprise Zones: N/A
Historic Districts: N/A
Elementary School District: EA Gibson
Middle School District: O.T. Bonner

Value Information

Land Value: \$500
Land Use Value: N/A
Improvement: N/A
Total: \$500

Additional Information

State Code: 1091 Vac Res Lot Buildable - 1
Land Use: Residential
Tax Map: 1807002000017000
Approx. Acres: 0.167
Legal Description: NO 27 SEC A LANSDALE ST
Zone: OTR Old Town Residential
Notes: DB 22-846: Affidavit with Merger from SCC attached, effective 3/1/18 & 30 lists. DB 05-5835: 17 lists.



Land

**Land area is based on information available, therefore acreage and/or square footage may be approximated.*

Land Code: Res Lots FV 500	Rate: \$500
Acres/Units: N/A	Adj. Rate: \$500
Sq. Ft.: N/A	Base Value: N/A
Front: N/A	Adj. Amount: N/A
Effective Front: N/A	Value: \$500
Depth: N/A	



Transfers

Deed:	Page:	Sale Date:	Sale Price:	Previous Owner:	Owner:
D 22	846	02/17/2022	N/A	DODSON GROUP INC	MARY & K D'S DINER INC
D 05	5835	11/18/2005	\$100,000	HOUSEMOVERS OF DANVILLE	DODSON GROUP INC
DP415	541	11/28/1961	N/A	N/A	N/A



Assessments

Year:	Land:	Use:	Improvements:	Total:
2023	\$500	N/A	N/A	\$500
2022	\$500	N/A	N/A	\$500
2021	\$500	N/A	N/A	\$500
2020	\$500	N/A	N/A	\$500
2019	\$500	N/A	N/A	\$500
2018	\$500	N/A	N/A	\$500
2017	\$500	N/A	N/A	\$500
2016	\$500	N/A	N/A	\$500
2015	\$500	N/A	N/A	\$500
2014	\$500	N/A	N/A	\$500
2013	\$500	N/A	N/A	\$500
2012	\$500	N/A	N/A	\$500
2011	\$500	N/A	N/A	\$500
2010	\$500	N/A	N/A	\$500
2009	\$500	N/A	N/A	\$500
2008	\$500	N/A	N/A	\$500
2007	\$500	N/A	N/A	\$500
2006	\$500	N/A	N/A	\$500
2005	\$500	N/A	N/A	\$500
2004	\$500	N/A	N/A	\$500
2003	\$500	N/A	N/A	\$500
2002	\$500	N/A	N/A	\$500
2001	\$500	N/A	N/A	\$500
2000	\$500	N/A	N/A	\$500

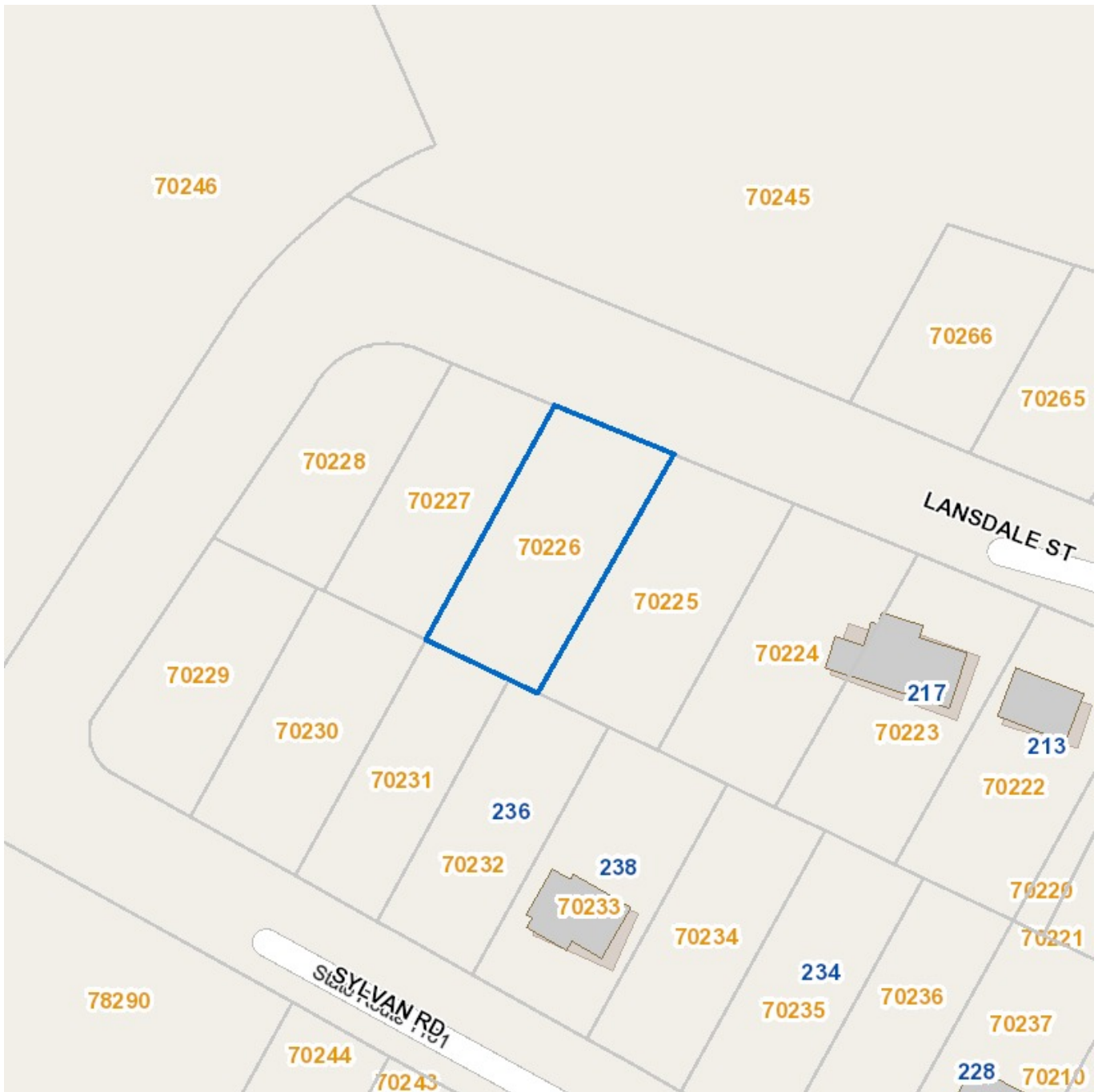



LANSDALE ST

Summary

Parcel ID: 70227
Address: LANSDALE ST

Owner Information

Owner Name: MARY & K D'S DINER INC
Owner Address: 1203 PINEY FOREST RD
Mail-To: MARY & K D'S DINER INC
Mailing Address: 1203 PINEY FOREST RD, DANVILLE, VA 24540

Land Information

Flood Zones: N/A
Enterprise Zones: N/A
Historic Districts: N/A
Elementary School District: EA Gibson
Middle School District: O.T. Bonner

Value Information

Land Value: \$500
Land Use Value: N/A
Improvement: N/A
Total: \$500

Additional Information

State Code: 1091 Vac Res Lot Buildable - 1
Land Use: Residential
Tax Map: 1807002000016000
Approx. Acres: 0.1441
Legal Description: NO 28 SEC A LANSDALE ST
Zone: OTR Old Town Residential
Notes: DB 22-846: Affidavit with Merger from SCC attached, effective 3/1/18 & 30 lists. DB 05-5835: 17 lists.



Land

**Land area is based on information available, therefore acreage and/or square footage may be approximated.*

Land Code: Res Lots FV 500

Rate: \$500

Acres/Units: N/A

Adj. Rate: \$500

Sq. Ft.: N/A

Base Value: N/A

Front: N/A

Adj. Amount: N/A

Effective Front: N/A

Value: \$500

Depth: N/A



Transfers

Deed:	Page:	Sale Date:	Sale Price:	Previous Owner:	Owner:
D 22	846	02/17/2022	N/A	DODSON GROUP INC	MARY & K D'S DINER INC
D 05	5835	11/18/2005	\$100,000	HOUSEMOVERS OF DANVILLE	DODSON GROUP INC
DP415	541	11/28/1961	N/A	N/A	N/A



Assessments

Year:	Land:	Use:	Improvements:	Total:
2023	\$500	N/A	N/A	\$500
2022	\$500	N/A	N/A	\$500
2021	\$500	N/A	N/A	\$500
2020	\$500	N/A	N/A	\$500
2019	\$500	N/A	N/A	\$500
2018	\$500	N/A	N/A	\$500
2017	\$500	N/A	N/A	\$500
2016	\$500	N/A	N/A	\$500
2015	\$500	N/A	N/A	\$500
2014	\$500	N/A	N/A	\$500
2013	\$500	N/A	N/A	\$500
2012	\$500	N/A	N/A	\$500
2011	\$500	N/A	N/A	\$500
2010	\$500	N/A	N/A	\$500
2009	\$500	N/A	N/A	\$500
2008	\$500	N/A	N/A	\$500
2007	\$500	N/A	N/A	\$500
2006	\$500	N/A	N/A	\$500
2005	\$500	N/A	N/A	\$500
2004	\$500	N/A	N/A	\$500
2003	\$500	N/A	N/A	\$500
2002	\$500	N/A	N/A	\$500
2001	\$500	N/A	N/A	\$500
2000	\$500	N/A	N/A	\$500

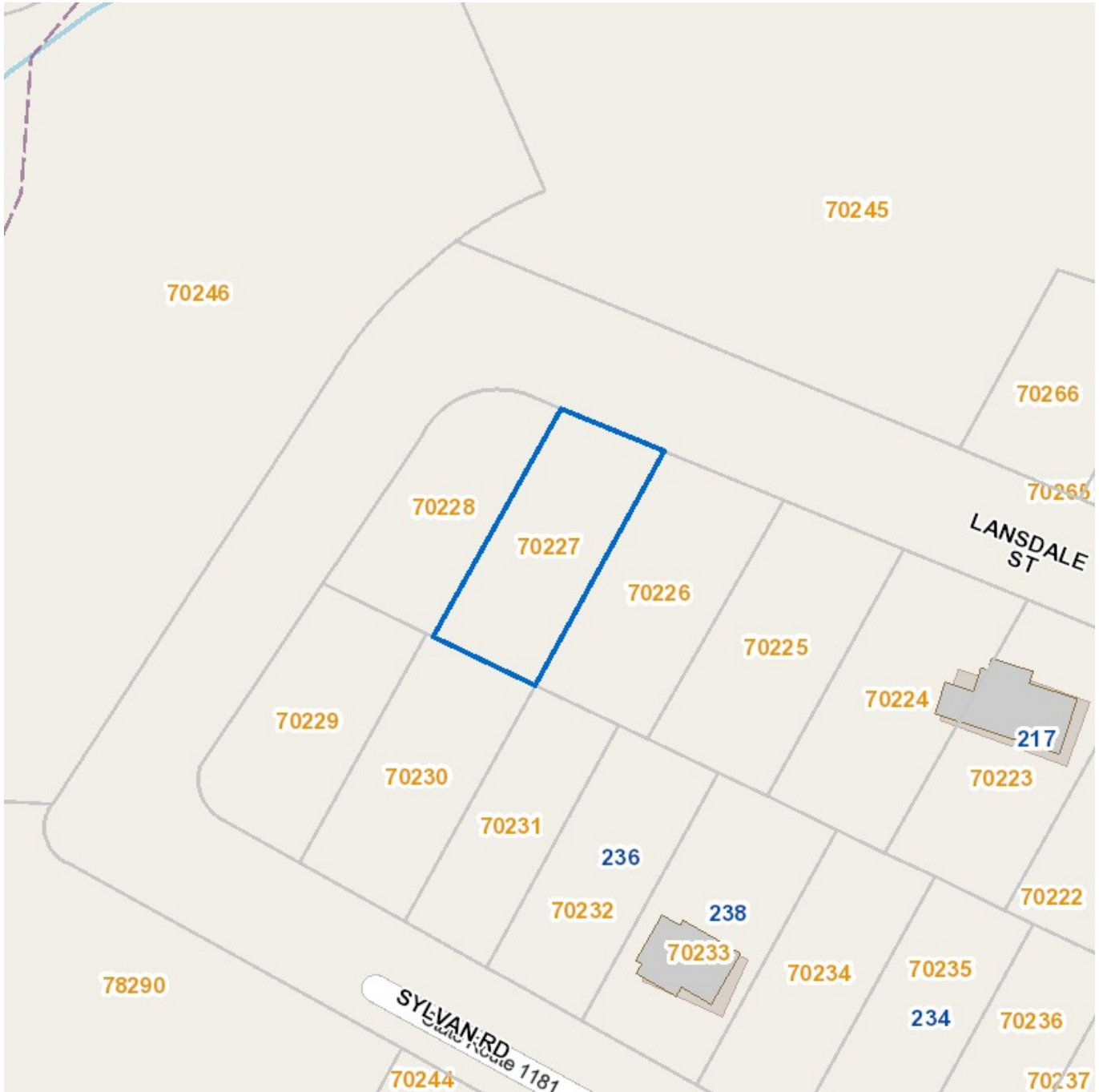



LANSDALE ST

Summary

Parcel ID: 70228
Address: LANSDALE ST

Owner Information

Owner Name: MARY & K D'S DINER INC
Owner Address: 1203 PINEY FOREST RD
Mail-To: MARY & K D'S DINER INC
Mailing Address: 1203 PINEY FOREST RD, DANVILLE, VA 24540

Land Information

Flood Zones: N/A
Enterprise Zones: N/A
Historic Districts: N/A
Elementary School District: EA Gibson
Middle School District: O.T. Bonner

Value Information

Land Value: \$500
Land Use Value: N/A
Improvement: N/A
Total: \$500

Additional Information

State Code: 1091 Vac Res Lot Buildable - 1
Land Use: Residential
Tax Map: 1807002000015000
Approx. Acres: 0.1372
Legal Description: NO 29 SEC A LANSDALE ST
Zone: OTR Old Town Residential
Notes: DB 22-846: Affidavit with Merger from SCC attached, effective 3/1/18 & 30 lists. DB 05-5835: 17 lists.



Land

**Land area is based on information available, therefore acreage and/or square footage may be approximated.*

Land Code: Res Lots FV 500

Rate: \$500

Acres/Units: N/A

Adj. Rate: \$500

Sq. Ft.: N/A

Base Value: N/A

Front: N/A

Adj. Amount: N/A

Effective Front: N/A

Value: \$500

Depth: N/A



Transfers

Deed:	Page:	Sale Date:	Sale Price:	Previous Owner:	Owner:
D 22	846	02/17/2022	N/A	DODSON GROUP INC	MARY & K D'S DINER INC
D 05	5835	11/18/2005	\$100,000	HOUSEMOVERS OF DANVILLE	DODSON GROUP INC
DP415	541	11/28/1961	N/A	N/A	N/A



Assessments

Year:	Land:	Use:	Improvements:	Total:
2023	\$500	N/A	N/A	\$500
2022	\$500	N/A	N/A	\$500
2021	\$500	N/A	N/A	\$500
2020	\$500	N/A	N/A	\$500
2019	\$500	N/A	N/A	\$500
2018	\$500	N/A	N/A	\$500
2017	\$500	N/A	N/A	\$500
2016	\$500	N/A	N/A	\$500
2015	\$500	N/A	N/A	\$500
2014	\$500	N/A	N/A	\$500
2013	\$500	N/A	N/A	\$500
2012	\$500	N/A	N/A	\$500
2011	\$500	N/A	N/A	\$500
2010	\$500	N/A	N/A	\$500
2009	\$500	N/A	N/A	\$500
2008	\$500	N/A	N/A	\$500
2007	\$500	N/A	N/A	\$500
2006	\$500	N/A	N/A	\$500
2005	\$500	N/A	N/A	\$500
2004	\$500	N/A	N/A	\$500
2003	\$500	N/A	N/A	\$500
2002	\$500	N/A	N/A	\$500
2001	\$500	N/A	N/A	\$500
2000	\$500	N/A	N/A	\$500

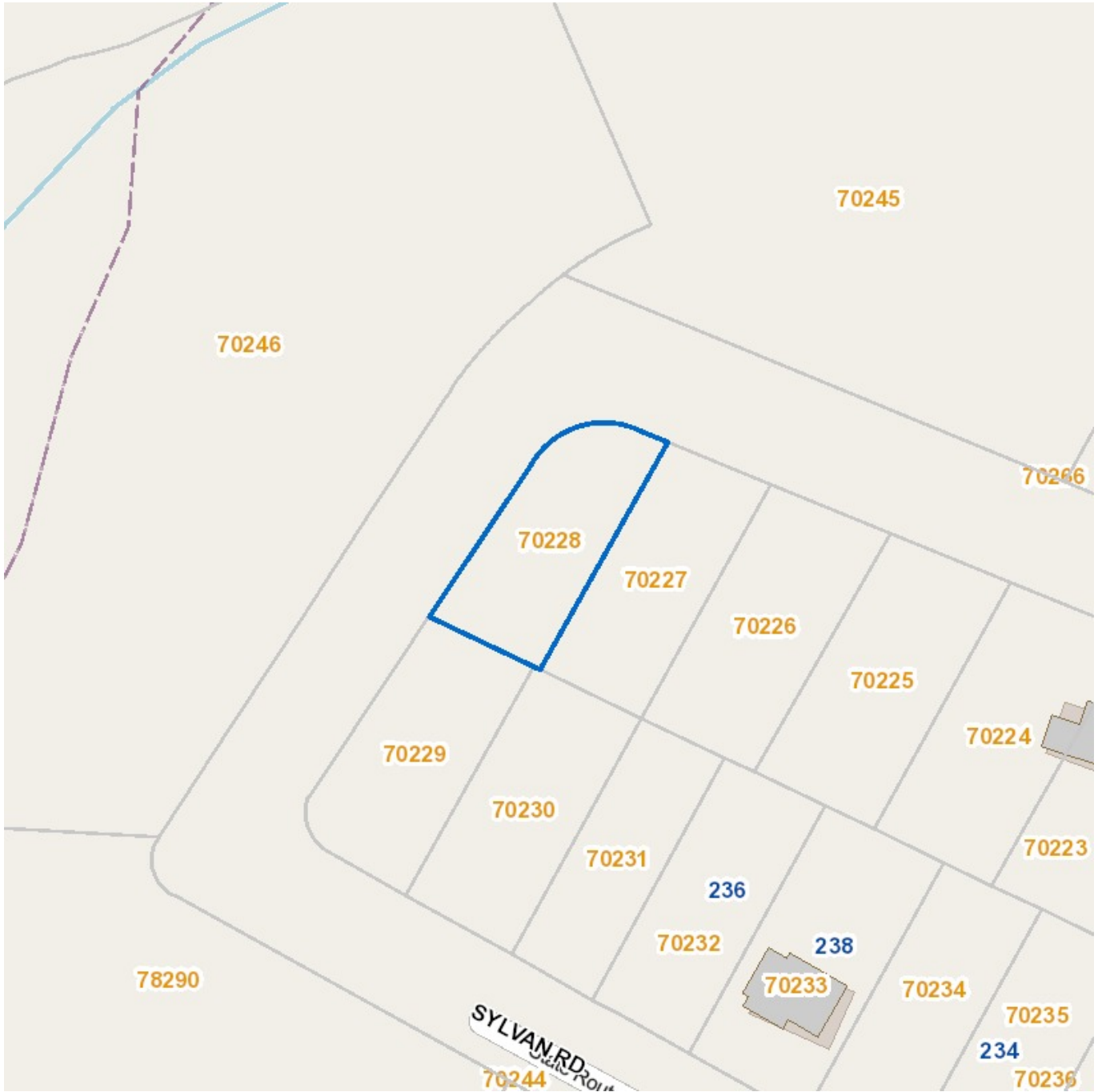



SYLVAN RD

Summary

Parcel ID: 70229
Address: SYLVAN RD

Owner Information

Owner Name: MARY & K D'S DINER INC
Owner Address: 1203 PINEY FOREST RD
Mail-To: MARY & K D'S DINER INC
Mailing Address: 1203 PINEY FOREST RD, DANVILLE, VA 24540

Land Information

Flood Zones: N/A
Enterprise Zones: N/A
Historic Districts: N/A
Elementary School District: EA Gibson
Middle School District: O.T. Bonner

Value Information

Land Value: \$500
Land Use Value: N/A
Improvement: N/A
Total: \$500

Additional Information

State Code: 1091 Vac Res Lot Buildable - 1
Land Use: Residential
Tax Map: 1807002000014000
Approx. Acres: 0.1563
Legal Description: NO 30 SEC A SYLVAN RD
Zone: OTR Old Town Residential
Notes: DB 22-846: Affidavit with Merger from SCC attached, effective 3/1/18 & 30 lists. DB 05-5835: 17 lists.



Land

**Land area is based on information available, therefore acreage and/or square footage may be approximated.*

Land Code: Res Lots FV 500	Rate: \$500
Acres/Units: N/A	Adj. Rate: \$500
Sq. Ft.: N/A	Base Value: N/A
Front: N/A	Adj. Amount: N/A
Effective Front: N/A	Value: \$500
Depth: N/A	



Transfers

Deed:	Page:	Sale Date:	Sale Price:	Previous Owner:	Owner:
D 22	846	02/17/2022	N/A	DODSON GROUP INC	MARY & K D'S DINER INC
D 05	5835	11/18/2005	\$100,000	HOUSEMOVERS OF DANVILLE	DODSON GROUP INC
DP415	541	11/28/1961	N/A	N/A	N/A



Assessments

Year:	Land:	Use:	Improvements:	Total:
2023	\$500	N/A	N/A	\$500
2022	\$500	N/A	N/A	\$500
2021	\$500	N/A	N/A	\$500
2020	\$500	N/A	N/A	\$500
2019	\$500	N/A	N/A	\$500
2018	\$500	N/A	N/A	\$500
2017	\$500	N/A	N/A	\$500
2016	\$500	N/A	N/A	\$500
2015	\$500	N/A	N/A	\$500
2014	\$500	N/A	N/A	\$500
2013	\$500	N/A	N/A	\$500
2012	\$500	N/A	N/A	\$500
2011	\$500	N/A	N/A	\$500
2010	\$500	N/A	N/A	\$500
2009	\$500	N/A	N/A	\$500
2008	\$500	N/A	N/A	\$500
2007	\$500	N/A	N/A	\$500
2006	\$500	N/A	N/A	\$500
2005	\$500	N/A	N/A	\$500
2004	\$500	N/A	N/A	\$500
2003	\$500	N/A	N/A	\$500
2002	\$500	N/A	N/A	\$500
2001	\$500	N/A	N/A	\$500
2000	\$500	N/A	N/A	\$500

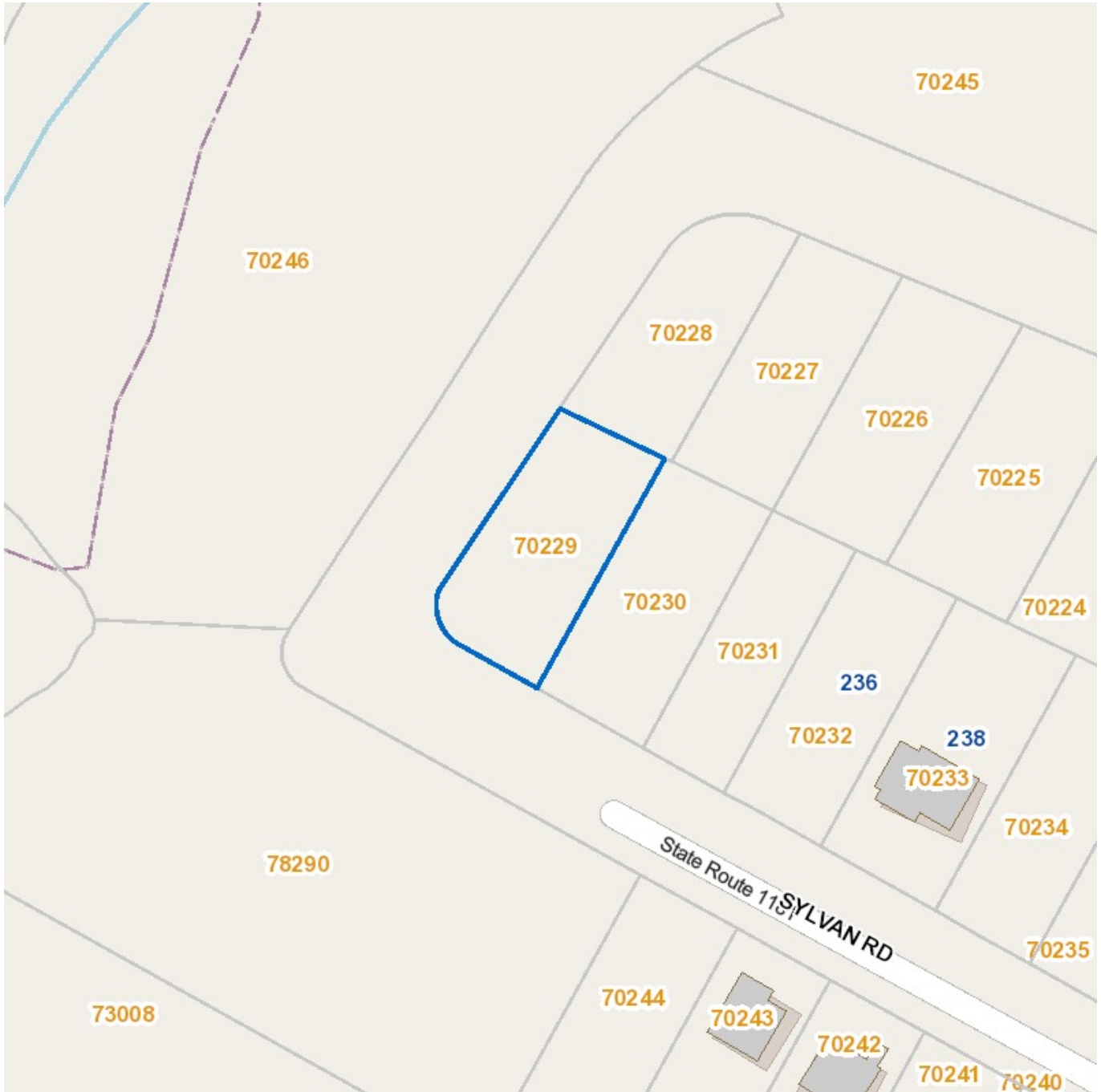



SYLVAN RD

Summary

Parcel ID: 70230
Address: SYLVAN RD

Owner Information

Owner Name: MARY & K D'S DINER INC
Owner Address: 1203 PINEY FOREST RD
Mail-To: MARY & K D'S DINER INC
Mailing Address: 1203 PINEY FOREST RD, DANVILLE, VA 24540

Land Information

Flood Zones: N/A
Enterprise Zones: N/A
Historic Districts: N/A
Elementary School District: EA Gibson
Middle School District: O.T. Bonner

Value Information

Land Value: \$2,500
Land Use Value: N/A
Improvement: N/A
Total: \$2,500

Additional Information

State Code: 1091 Vac Res Lot Buildable - 1
Land Use: Residential
Tax Map: 1807002000013000
Approx. Acres: 0.1566
Legal Description: NO 31 SEC A SYLVAN RD
Zone: OTR Old Town Residential
Notes: DB 22-846: Affidavit with Merger from SCC attached, effective 3/1/18 & 30 lists. DB 05-5835: 17 lists.



Land

**Land area is based on information available, therefore acreage and/or square footage may be approximated.*

Land Code: Res Lots FV 2500	Rate: \$2,500
Acres/Units: N/A	Adj. Rate: \$2,500
Sq. Ft.: N/A	Base Value: N/A
Front: N/A	Adj. Amount: N/A
Effective Front: N/A	Value: \$2,500
Depth: N/A	



Transfers

Deed:	Page:	Sale Date:	Sale Price:	Previous Owner:	Owner:
D 22	846	02/17/2022	N/A	DODSON GROUP INC	MARY & K D'S DINER INC
D 05	5835	11/18/2005	\$100,000	HOUSEMOVERS OF DANVILLE	DODSON GROUP INC
DP415	541	11/28/1961	N/A	N/A	N/A



Assessments

Year:	Land:	Use:	Improvements:	Total:
2023	\$2,500	N/A	N/A	\$2,500
2022	\$2,500	N/A	N/A	\$2,500
2021	\$2,500	N/A	N/A	\$2,500
2020	\$2,500	N/A	N/A	\$2,500
2019	\$2,500	N/A	N/A	\$2,500
2018	\$2,500	N/A	N/A	\$2,500
2017	\$2,500	N/A	N/A	\$2,500
2016	\$2,500	N/A	N/A	\$2,500
2015	\$2,500	N/A	N/A	\$2,500
2014	\$2,500	N/A	N/A	\$2,500
2013	\$2,500	N/A	N/A	\$2,500
2012	\$2,500	N/A	N/A	\$2,500
2011	\$2,500	N/A	N/A	\$2,500
2010	\$2,500	N/A	N/A	\$2,500
2009	\$2,500	N/A	N/A	\$2,500
2008	\$2,500	N/A	N/A	\$2,500
2007	\$2,500	N/A	N/A	\$2,500
2006	\$2,500	N/A	N/A	\$2,500
2005	\$2,500	N/A	N/A	\$2,500
2004	\$2,500	N/A	N/A	\$2,500
2003	\$2,500	N/A	N/A	\$2,500
2002	\$2,500	N/A	N/A	\$2,500
2001	\$2,500	N/A	N/A	\$2,500
2000	\$2,500	N/A	N/A	\$2,500

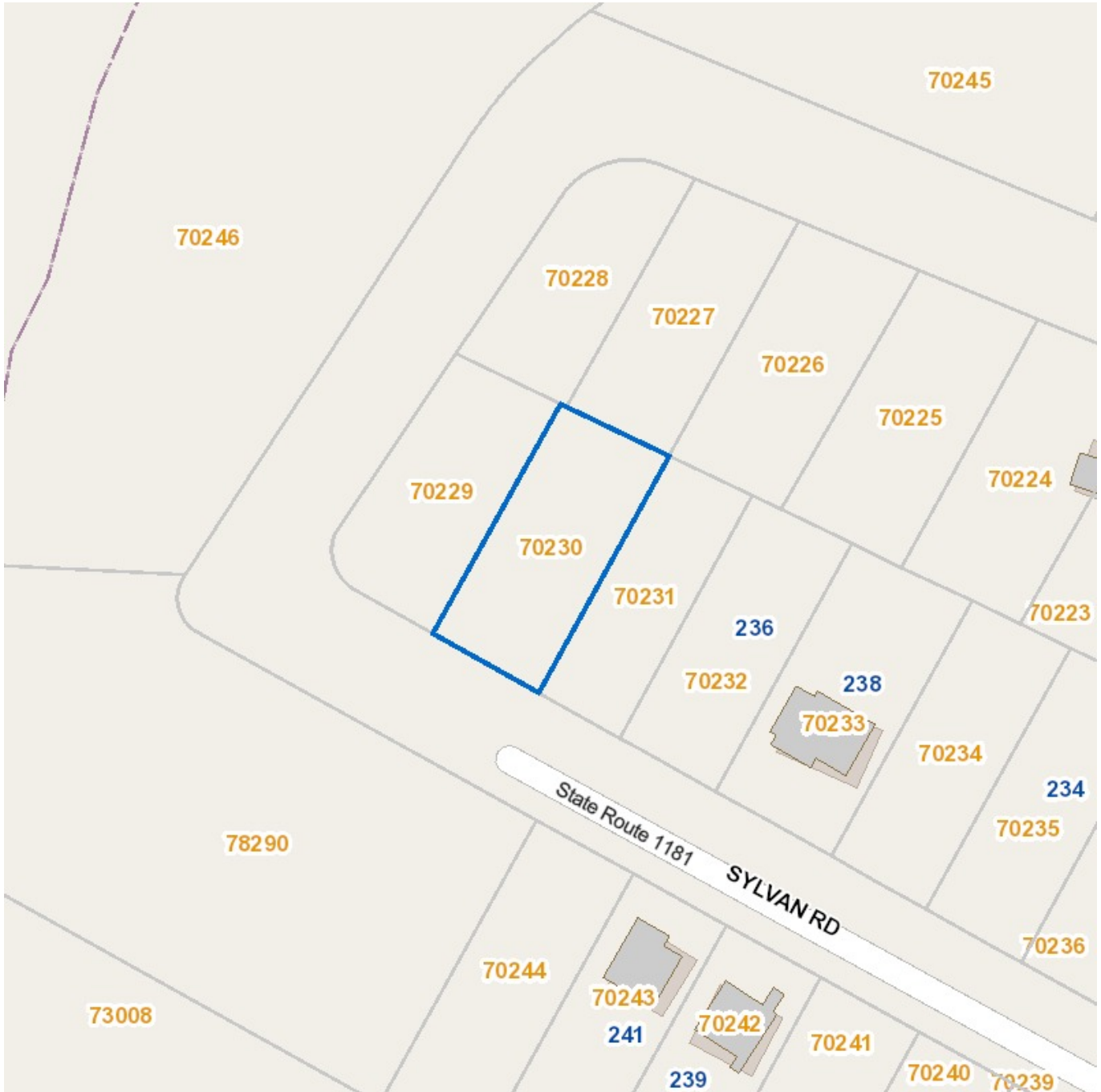



SYLVAN RD

Summary

Parcel ID: 70231
Address: SYLVAN RD

Owner Information

Owner Name: MARY & K D'S DINER INC
Owner Address: 1203 PINEY FOREST RD
Mail-To: MARY & K D'S DINER INC
Mailing Address: 1203 PINEY FOREST RD, DANVILLE, VA 24540

Land Information

Flood Zones: N/A
Enterprise Zones: N/A
Historic Districts: N/A
Elementary School District: EA Gibson
Middle School District: O.T. Bonner

Value Information

Land Value: \$2,000
Land Use Value: N/A
Improvement: N/A
Total: \$2,000

Additional Information

State Code: 1091 Vac Res Lot Buildable - 1
Land Use: Residential
Tax Map: 1807002000012000
Approx. Acres: 0.1228
Legal Description: PT NO 32 SEC A SYLVAN RD
Zone: OTR Old Town Residential
Notes: DB 22-846: Affidavit with Merger from SCC attached, effective 3/1/18 & 30 lists. DB 05-5835: 17 lists.



Land

**Land area is based on information available, therefore acreage and/or square footage may be approximated.*

Land Code: Res Lots FV 2000	Rate: \$2,000
Acres/Units: N/A	Adj. Rate: \$2,000
Sq. Ft.: N/A	Base Value: N/A
Front: N/A	Adj. Amount: N/A
Effective Front: N/A	Value: \$2,000
Depth: N/A	



Transfers

Deed:	Page:	Sale Date:	Sale Price:	Previous Owner:	Owner:
D 22	846	02/17/2022	N/A	DODSON GROUP INC	MARY & K D'S DINER INC
D 05	5835	11/18/2005	\$100,000	HOUSEMOVERS OF DANVILLE	DODSON GROUP INC
DP403	254	10/27/1960	N/A	N/A	N/A



Assessments

Year:	Land:	Use:	Improvements:	Total:
2023	\$2,000	N/A	N/A	\$2,000
2022	\$2,000	N/A	N/A	\$2,000
2021	\$2,000	N/A	N/A	\$2,000
2020	\$2,000	N/A	N/A	\$2,000
2019	\$2,000	N/A	N/A	\$2,000
2018	\$2,000	N/A	N/A	\$2,000
2017	\$2,000	N/A	N/A	\$2,000
2016	\$2,000	N/A	N/A	\$2,000
2015	\$2,000	N/A	N/A	\$2,000
2014	\$2,000	N/A	N/A	\$2,000
2013	\$2,000	N/A	N/A	\$2,000
2012	\$2,000	N/A	N/A	\$2,000
2011	\$2,000	N/A	N/A	\$2,000
2010	\$2,000	N/A	N/A	\$2,000
2009	\$2,000	N/A	N/A	\$2,000
2008	\$2,000	N/A	N/A	\$2,000
2007	\$2,000	N/A	N/A	\$2,000
2006	\$2,000	N/A	N/A	\$2,000
2005	\$2,000	N/A	N/A	\$2,000
2004	\$2,000	N/A	N/A	\$2,000
2003	\$2,000	N/A	N/A	\$2,000
2002	\$2,000	N/A	N/A	\$2,000
2001	\$2,000	N/A	N/A	\$2,000
2000	\$2,000	N/A	N/A	\$2,000

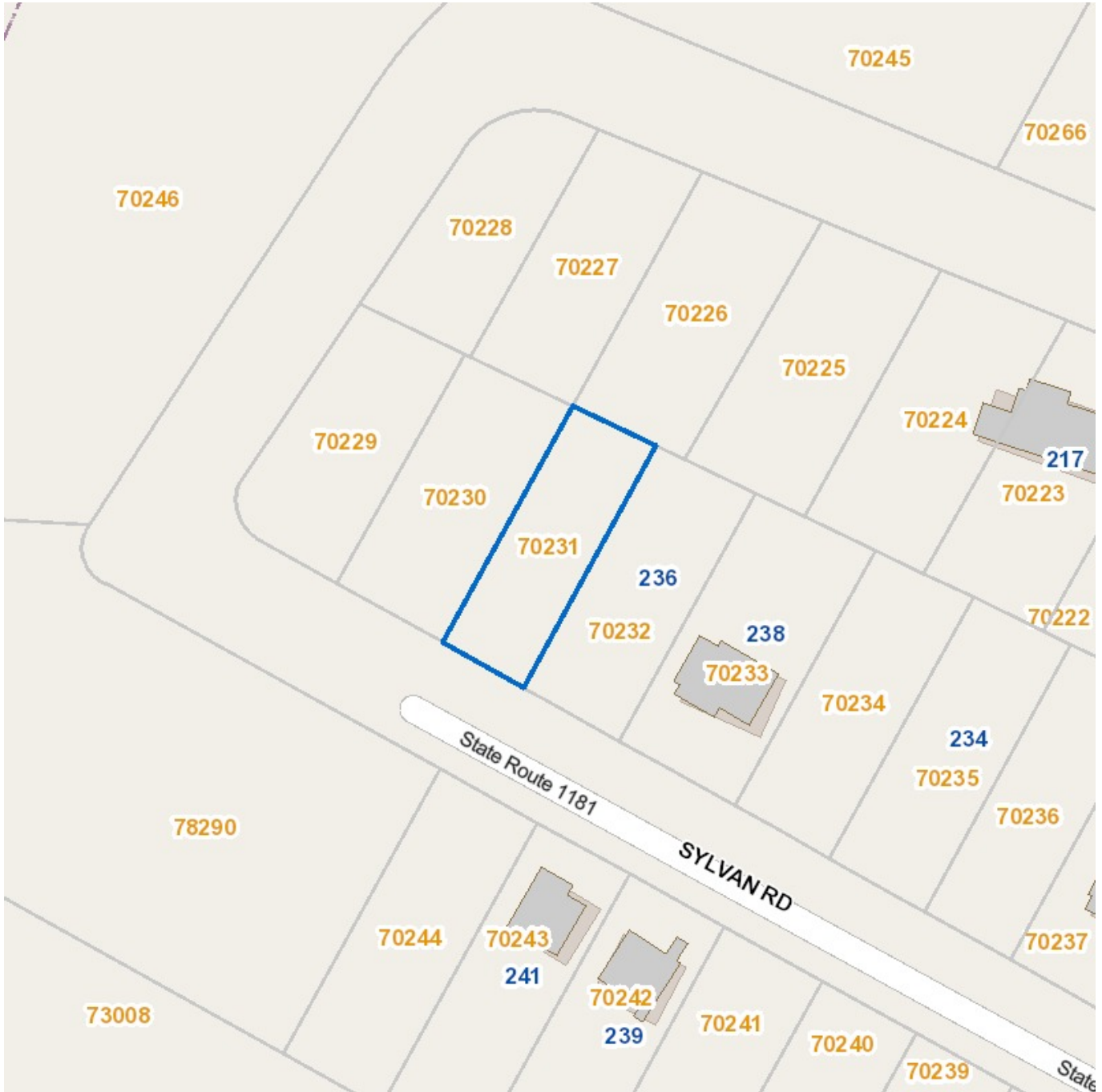



LANSDALE ST

Summary

Parcel ID: 70245
Address: LANSDALE ST

Owner Information

Owner Name: MARY & K D'S DINER INC
Owner Address: 1203 PINEY FOREST RD
Mail-To: MARY & K D'S DINER INC
Mailing Address: 1203 PINEY FOREST RD, DANVILLE, VA 24540

Land Information

Flood Zones: N/A
Enterprise Zones: N/A
Historic Districts: N/A
Elementary School District: EA Gibson
Middle School District: O.T. Bonner

Value Information

Land Value: \$6,100
Land Use Value: N/A
Improvement: N/A
Total: \$6,100

Additional Information

State Code: 1091 Vac Res Lot Buildable - 1
Land Use: Residential
Tax Map: 1807003000014000
Approx. Acres: 4.986
Legal Description: 5.049 AC TRACT 1 SEC B LANSDALE ST & SYLVAN RD
Zone: MR Multi-Family Residential
Notes: DB 22-846: Affidavit with Merger from SCC attached, effective 3/1/18 & 30 lists. DB 05-5835: 17 lists.



Land

**Land area is based on information available, therefore acreage and/or square footage may be approximated.*

Land Code: RA13 1200	Rate: \$1,200
Acres/Units: 5.05	Adj. Rate: \$1,200
Sq. Ft.: 219978	Base Value: \$6,060
Front: N/A	Adj. Amount: \$40
Effective Front: N/A	Value: \$6,100
Depth: N/A	



Transfers

Deed:	Page:	Sale Date:	Sale Price:	Previous Owner:	Owner:
D 22	846	02/17/2022	N/A	DODSON GROUP INC	MARY & K D'S DINER INC
D 05	5835	11/18/2005	\$100,000	HOUSEMOVERS OF DANVILLE	DODSON GROUP INC
DP387	426	02/27/1959	N/A	N/A	N/A



Assessments

Year:	Land:	Use:	Improvements:	Total:
2023	\$6,100	N/A	N/A	\$6,100
2022	\$6,100	N/A	N/A	\$6,100
2021	\$6,100	N/A	N/A	\$6,100
2020	\$6,100	N/A	N/A	\$6,100
2019	\$6,100	N/A	N/A	\$6,100
2018	\$6,100	N/A	N/A	\$6,100
2017	\$6,100	N/A	N/A	\$6,100
2016	\$6,100	N/A	N/A	\$6,100
2015	\$6,100	N/A	N/A	\$6,100
2014	\$6,100	N/A	N/A	\$6,100
2013	\$6,100	N/A	N/A	\$6,100
2012	\$6,100	N/A	N/A	\$6,100
2011	\$6,100	N/A	N/A	\$6,100
2010	\$6,100	N/A	N/A	\$6,100
2009	\$6,100	N/A	N/A	\$6,100
2008	\$6,100	N/A	N/A	\$6,100
2007	\$6,100	N/A	N/A	\$6,100
2006	\$6,100	N/A	N/A	\$6,100
2005	\$5,700	N/A	N/A	\$5,700
2004	\$5,700	N/A	N/A	\$5,700
2003	\$7,000	N/A	N/A	\$7,000
2002	\$7,000	N/A	N/A	\$7,000
2001	\$7,000	N/A	N/A	\$7,000
2000	\$7,000	N/A	N/A	\$7,000





SYLVAN RD

Summary

Parcel ID: 70246
Address: SYLVAN RD

Owner Information

Owner Name: MARY & K D'S DINER INC
Owner Address: 1203 PINEY FOREST RD
Mail-To: MARY & K D'S DINER INC
Mailing Address: 1203 PINEY FOREST RD, DANVILLE, VA 24540

Land Information

Flood Zones: N/A
Enterprise Zones: N/A
Historic Districts: N/A
Elementary School District: EA Gibson
Middle School District: O.T. Bonner

Value Information

Land Value: \$1,000
Land Use Value: N/A
Improvement: N/A
Total: \$1,000

Additional Information

State Code: 1091 Vac Res Lot Buildable - 1
Land Use: Residential
Tax Map: 1807003000015000
Approx. Acres: 2.281
Legal Description: NO 43-47 SEC A1 & NO 35 SEC B SYLVAN RD
Zone: OTR Old Town Residential
Notes: DB 22-846: Affidavit with Merger from SCC attached, effective 3/1/18 & 30 lists. DB 05-5835: 17 lists.



Land

**Land area is based on information available, therefore acreage and/or square footage may be approximated.*

Land Code: Res Lots FV 1000

Rate: \$1,000

Acres/Units: N/A

Adj. Rate: \$1,000

Sq. Ft.: N/A

Base Value: N/A

Front: N/A

Adj. Amount: N/A

Effective Front: N/A

Value: \$1,000

Depth: N/A



Transfers

Deed:	Page:	Sale Date:	Sale Price:	Previous Owner:	Owner:
D 22	846	02/17/2022	N/A	DODSON GROUP INC	MARY & K D'S DINER INC
D 05	5835	11/18/2005	\$100,000	HOUSEMOVERS OF DANVILLE	DODSON GROUP INC
DP415	541	N/A	N/A	N/A	N/A



Assessments

Year:	Land:	Use:	Improvements:	Total:
2023	\$1,000	N/A	N/A	\$1,000
2022	\$1,000	N/A	N/A	\$1,000
2021	\$1,000	N/A	N/A	\$1,000
2020	\$1,000	N/A	N/A	\$1,000
2019	\$1,000	N/A	N/A	\$1,000
2018	\$1,000	N/A	N/A	\$1,000
2017	\$1,000	N/A	N/A	\$1,000
2016	\$1,000	N/A	N/A	\$1,000
2015	\$1,000	N/A	N/A	\$1,000
2014	\$1,000	N/A	N/A	\$1,000
2013	\$1,000	N/A	N/A	\$1,000
2012	\$1,000	N/A	N/A	\$1,000
2011	\$1,000	N/A	N/A	\$1,000
2010	\$1,000	N/A	N/A	\$1,000
2009	\$1,000	N/A	N/A	\$1,000
2008	\$1,000	N/A	N/A	\$1,000
2007	\$1,000	N/A	N/A	\$1,000
2006	\$1,000	N/A	N/A	\$1,000
2005	\$1,000	N/A	N/A	\$1,000
2004	\$1,000	N/A	N/A	\$1,000
2003	\$1,000	N/A	N/A	\$1,000
2002	\$1,000	N/A	N/A	\$1,000
2001	\$1,000	N/A	N/A	\$1,000
2000	\$1,000	N/A	N/A	\$1,000





SYLVAN RD

Summary

Parcel ID: 70252
Address: SYLVAN RD

Owner Information

Owner Name: MARY & K D'S DINER INC
Owner Address: 1203 PINEY FOREST RD
Mail-To: MARY & K D'S DINER INC
Mailing Address: 1203 PINEY FOREST RD, DANVILLE, VA 24540

Land Information

Flood Zones: N/A
Enterprise Zones: N/A
Historic Districts: N/A

Elementary School District: EA Gibson

Middle School District: O.T. Bonner

Value Information

Land Value: \$500
Land Use Value: N/A
Improvement: N/A
Total: \$500

Additional Information

State Code: 1091 Vac Res Lot Buildable - 1
Land Use: Residential
Tax Map: 1807003000001000
Approx. Acres: 0.1603
Legal Description: NO 9 SEC B (.17 AC) SYLVAN RD
Zone: OTR Old Town Residential
Notes: DB 22-846: Affidavit with Merger from SCC attached, effective 3/1/18 & 30 lists. WB 05-295: James died 11/19/92 & 2 lists incl acct# 25266 & 70252.



Land

**Land area is based on information available, therefore acreage and/or square footage may be approximated.*

Land Code: Res Lots FV 500	Rate: \$500
Acres/Units: N/A	Adj. Rate: \$500
Sq. Ft.: N/A	Base Value: N/A
Front: N/A	Adj. Amount: N/A
Effective Front: N/A	Value: \$500
Depth: N/A	



Transfers

Deed:	Page:	Sale Date:	Sale Price:	Previous Owner:	Owner:
D 22	846	02/17/2022	N/A	DODSON GROUP INC	MARY & K D'S DINER INC
D 07	4464	09/14/2007	\$10,000	NELSON MATTIE H	DODSON GROUP INC
W 05	295	10/18/2005	N/A	NELSON JAMES LEE	NELSON MATTIE H
DP413	472	N/A	\$395	N/A	NELSON JAMES LEE & MATTIE H



Assessments

Year:	Land:	Use:	Improvements:	Total:
2023	\$500	N/A	N/A	\$500
2022	\$500	N/A	N/A	\$500
2021	\$500	N/A	N/A	\$500
2020	\$500	N/A	N/A	\$500
2019	\$500	N/A	N/A	\$500
2018	\$500	N/A	N/A	\$500
2017	\$500	N/A	N/A	\$500
2016	\$500	N/A	N/A	\$500
2015	\$500	N/A	N/A	\$500
2014	\$500	N/A	N/A	\$500
2013	\$500	N/A	N/A	\$500
2012	\$500	N/A	N/A	\$500
2011	\$500	N/A	N/A	\$500
2010	\$500	N/A	N/A	\$500
2009	\$500	N/A	N/A	\$500
2008	\$500	N/A	N/A	\$500
2007	\$500	N/A	N/A	\$500
2006	\$500	N/A	N/A	\$500
2005	\$500	N/A	N/A	\$500
2004	\$500	N/A	N/A	\$500
2003	\$500	N/A	N/A	\$500
2002	\$500	N/A	N/A	\$500
2001	\$500	N/A	N/A	\$500
2000	\$500	N/A	N/A	\$500





SYLVAN RD

Summary

Parcel ID: 70253
Address: SYLVAN RD

Owner Information

Owner Name: MARY & K D'S DINER INC
Owner Address: 1203 PINEY FOREST RD
Mail-To: MARY & K D'S DINER INC
Mailing Address: 1203 PINEY FOREST RD, DANVILLE, VA 24540

Land Information

Flood Zones: N/A
Enterprise Zones: N/A
Historic Districts: N/A
Elementary School District: EA Gibson
Middle School District: O.T. Bonner

Value Information

Land Value: \$300
Land Use Value: N/A
Improvement: N/A
Total: \$300

Additional Information

State Code: 1091 Vac Res Lot Buildable - 1
Land Use: Residential
Tax Map: 1807003000002000
Approx. Acres: 0.2087
Legal Description: NO 10 SEC B SYLVAN RD
Zone: OTR Old Town Residential
Notes: DB 22-846: Affidavit with Merger from SCC attached, effective 3/1/18 & 30 lists. DB 05-5835: 17 lists.



Land

**Land area is based on information available, therefore acreage and/or square footage may be approximated.*

Land Code: Res Lots FV 300	Rate: \$300
Acres/Units: N/A	Adj. Rate: \$300
Sq. Ft.: N/A	Base Value: N/A
Front: N/A	Adj. Amount: N/A
Effective Front: N/A	Value: \$300
Depth: N/A	



Transfers

Deed:	Page:	Sale Date:	Sale Price:	Previous Owner:	Owner:
D 22	846	02/17/2022	N/A	DODSON GROUP INC	MARY & K D'S DINER INC
D 05	5835	11/18/2005	\$100,000	HOUSEMOVERS OF DANVILLE	DODSON GROUP INC
DP403	254	10/27/1960	N/A	N/A	N/A



Assessments

Year:	Land:	Use:	Improvements:	Total:
2023	\$300	N/A	N/A	\$300
2022	\$300	N/A	N/A	\$300
2021	\$300	N/A	N/A	\$300
2020	\$300	N/A	N/A	\$300
2019	\$300	N/A	N/A	\$300
2018	\$300	N/A	N/A	\$300
2017	\$300	N/A	N/A	\$300
2016	\$300	N/A	N/A	\$300
2015	\$300	N/A	N/A	\$300
2014	\$300	N/A	N/A	\$300
2013	\$300	N/A	N/A	\$300
2012	\$300	N/A	N/A	\$300
2011	\$300	N/A	N/A	\$300
2010	\$300	N/A	N/A	\$300
2009	\$300	N/A	N/A	\$300
2008	\$300	N/A	N/A	\$300
2007	\$300	N/A	N/A	\$300
2006	\$300	N/A	N/A	\$300
2005	\$300	N/A	N/A	\$300
2004	\$300	N/A	N/A	\$300
2003	\$300	N/A	N/A	\$300
2002	\$300	N/A	N/A	\$300
2001	\$300	N/A	N/A	\$300
2000	\$300	N/A	N/A	\$300

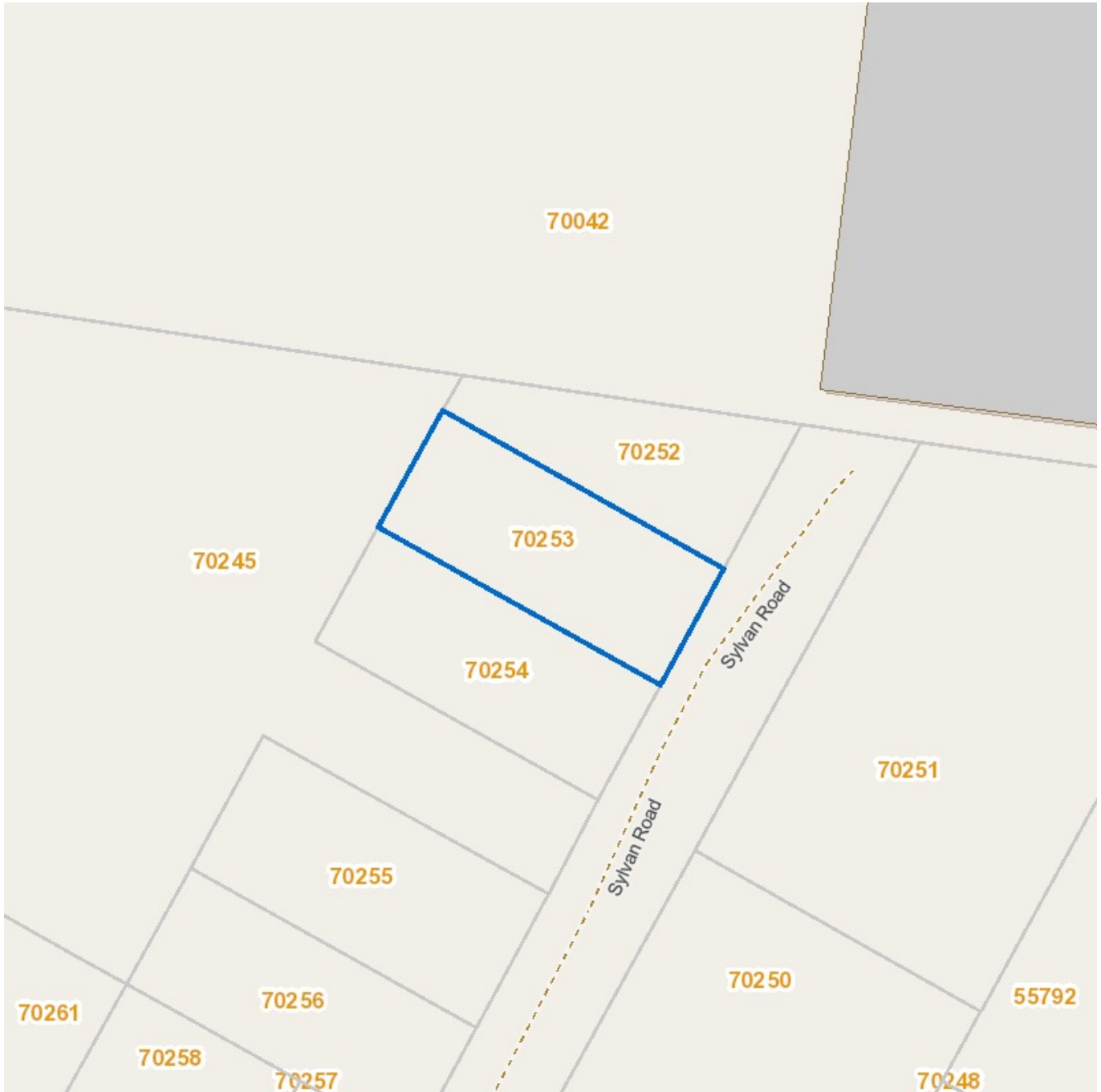



SYLVAN RD

Summary

Parcel ID: 70254
Address: SYLVAN RD

Owner Information

Owner Name: MARY & K D'S DINER INC
Owner Address: 1203 PINEY FOREST RD
Mail-To: MARY & K D'S DINER INC
Mailing Address: 1203 PINEY FOREST RD, DANVILLE, VA 24540

Land Information

Flood Zones: N/A
Enterprise Zones: N/A
Historic Districts: N/A
Elementary School District: EA Gibson
Middle School District: O.T. Bonner

Value Information

Land Value: \$300
Land Use Value: N/A
Improvement: N/A
Total: \$300

Additional Information

State Code: 1091 Vac Res Lot Buildable - 1
Land Use: Residential
Tax Map: 1807003000003000
Approx. Acres: 0.2053
Legal Description: NO 11 SEC B SYLVAN RD
Zone: OTR Old Town Residential
Notes: DB 22-846: Affidavit with Merger from SCC attached, effective 3/1/18 & 30 lists. DB 05-5835: 17 lists.



Land

**Land area is based on information available, therefore acreage and/or square footage may be approximated.*

Land Code: Res Lots FV 300	Rate: \$300
Acres/Units: N/A	Adj. Rate: \$300
Sq. Ft.: N/A	Base Value: N/A
Front: N/A	Adj. Amount: N/A
Effective Front: N/A	Value: \$300
Depth: N/A	



Transfers

Deed:	Page:	Sale Date:	Sale Price:	Previous Owner:	Owner:
D 22	846	02/17/2022	N/A	DODSON GROUP INC	MARY & K D'S DINER INC
D 05	5835	11/18/2005	\$100,000	HOUSEMOVERS OF DANVILLE	DODSON GROUP INC
DP403	254	10/27/1960	N/A	N/A	N/A



Assessments

Year:	Land:	Use:	Improvements:	Total:
2023	\$300	N/A	N/A	\$300
2022	\$300	N/A	N/A	\$300
2021	\$300	N/A	N/A	\$300
2020	\$300	N/A	N/A	\$300
2019	\$300	N/A	N/A	\$300
2018	\$300	N/A	N/A	\$300
2017	\$300	N/A	N/A	\$300
2016	\$300	N/A	N/A	\$300
2015	\$300	N/A	N/A	\$300
2014	\$300	N/A	N/A	\$300
2013	\$300	N/A	N/A	\$300
2012	\$300	N/A	N/A	\$300
2011	\$300	N/A	N/A	\$300
2010	\$300	N/A	N/A	\$300
2009	\$300	N/A	N/A	\$300
2008	\$300	N/A	N/A	\$300
2007	\$300	N/A	N/A	\$300
2006	\$300	N/A	N/A	\$300
2005	\$300	N/A	N/A	\$300
2004	\$300	N/A	N/A	\$300
2003	\$300	N/A	N/A	\$300
2002	\$300	N/A	N/A	\$300
2001	\$300	N/A	N/A	\$300
2000	\$300	N/A	N/A	\$300





SYLVAN RD

Summary

Parcel ID: 70255
Address: SYLVAN RD

Owner Information

Owner Name: MARY & K D'S DINER INC
Owner Address: 1203 PINEY FOREST RD
Mail-To: MARY & K D'S DINER INC
Mailing Address: 1203 PINEY FOREST RD, DANVILLE, VA 24540

Land Information

Flood Zones: N/A
Enterprise Zones: N/A
Historic Districts: N/A
Elementary School District: EA Gibson
Middle School District: O.T. Bonner

Value Information

Land Value: \$300
Land Use Value: N/A
Improvement: N/A
Total: \$300

Additional Information

State Code: 1091 Vac Res Lot Buildable - 1
Land Use: Residential
Tax Map: 1807003000004000
Approx. Acres: 0.2421
Legal Description: NO 12 SEC B SYLVAN RD
Zone: OTR Old Town Residential
Notes: DB 22-846: Affidavit with Merger from SCC attached, effective 3/1/18 & 30 lists. DB 05-5835: 17 lists.



Land

**Land area is based on information available, therefore acreage and/or square footage may be approximated.*

Land Code: Res Lots FV 300	Rate: \$300
Acres/Units: N/A	Adj. Rate: \$300
Sq. Ft.: N/A	Base Value: N/A
Front: N/A	Adj. Amount: N/A
Effective Front: N/A	Value: \$300
Depth: N/A	



Transfers

Deed:	Page:	Sale Date:	Sale Price:	Previous Owner:	Owner:
D 22	846	02/17/2022	N/A	DODSON GROUP INC	MARY & K D'S DINER INC
D 05	5835	11/18/2005	\$100,000	HOUSEMOVERS OF DANVILLE	DODSON GROUP INC
DP403	254	10/27/1960	N/A	N/A	N/A



Assessments

Year:	Land:	Use:	Improvements:	Total:
2023	\$300	N/A	N/A	\$300
2022	\$300	N/A	N/A	\$300
2021	\$300	N/A	N/A	\$300
2020	\$300	N/A	N/A	\$300
2019	\$300	N/A	N/A	\$300
2018	\$300	N/A	N/A	\$300
2017	\$300	N/A	N/A	\$300
2016	\$300	N/A	N/A	\$300
2015	\$300	N/A	N/A	\$300
2014	\$300	N/A	N/A	\$300
2013	\$300	N/A	N/A	\$300
2012	\$300	N/A	N/A	\$300
2011	\$300	N/A	N/A	\$300
2010	\$300	N/A	N/A	\$300
2009	\$300	N/A	N/A	\$300
2008	\$300	N/A	N/A	\$300
2007	\$300	N/A	N/A	\$300
2006	\$300	N/A	N/A	\$300
2005	\$300	N/A	N/A	\$300
2004	\$300	N/A	N/A	\$300
2003	\$300	N/A	N/A	\$300
2002	\$300	N/A	N/A	\$300
2001	\$300	N/A	N/A	\$300
2000	\$300	N/A	N/A	\$300





SYLVAN RD

Summary

Parcel ID: 70256
Address: SYLVAN RD

Owner Information

Owner Name: MARY & K D'S DINER INC
Owner Address: 1203 PINEY FOREST RD
Mail-To: MARY & K D'S DINER INC
Mailing Address: 1203 PINEY FOREST RD, DANVILLE, VA 24540

Land Information

Flood Zones: N/A
Enterprise Zones: N/A
Historic Districts: N/A
Elementary School District: EA Gibson
Middle School District: O.T. Bonner

Value Information

Land Value: \$300
Land Use Value: N/A
Improvement: N/A
Total: \$300

Additional Information

State Code: 1091 Vac Res Lot Buildable - 1
Land Use: Residential
Tax Map: 1807003000005000
Approx. Acres: 0.2108
Legal Description: NO 13 SEC B SYLVAN RD
Zone: OTR Old Town Residential
Notes: DB 22-846: Affidavit with Merger from SCC attached, effective 3/1/18 & 30 lists. DB 05-5835: 17 lists.



Land

**Land area is based on information available, therefore acreage and/or square footage may be approximated.*

Land Code: Res Lots FV 300	Rate: \$300
Acres/Units: N/A	Adj. Rate: \$300
Sq. Ft.: N/A	Base Value: N/A
Front: N/A	Adj. Amount: N/A
Effective Front: N/A	Value: \$300
Depth: N/A	



Transfers

Deed:	Page:	Sale Date:	Sale Price:	Previous Owner:	Owner:
D 22	846	02/17/2022	N/A	DODSON GROUP INC	MARY & K D'S DINER INC
D 05	5835	11/18/2005	\$100,000	HOUSEMOVERS OF DANVILLE	DODSON GROUP INC
DP403	254	10/27/1960	N/A	N/A	N/A



Assessments

Year:	Land:	Use:	Improvements:	Total:
2023	\$300	N/A	N/A	\$300
2022	\$300	N/A	N/A	\$300
2021	\$300	N/A	N/A	\$300
2020	\$300	N/A	N/A	\$300
2019	\$300	N/A	N/A	\$300
2018	\$300	N/A	N/A	\$300
2017	\$300	N/A	N/A	\$300
2016	\$300	N/A	N/A	\$300
2015	\$300	N/A	N/A	\$300
2014	\$300	N/A	N/A	\$300
2013	\$300	N/A	N/A	\$300
2012	\$300	N/A	N/A	\$300
2011	\$300	N/A	N/A	\$300
2010	\$300	N/A	N/A	\$300
2009	\$300	N/A	N/A	\$300
2008	\$300	N/A	N/A	\$300
2007	\$300	N/A	N/A	\$300
2006	\$300	N/A	N/A	\$300
2005	\$300	N/A	N/A	\$300
2004	\$300	N/A	N/A	\$300
2003	\$300	N/A	N/A	\$300
2002	\$300	N/A	N/A	\$300
2001	\$300	N/A	N/A	\$300
2000	\$300	N/A	N/A	\$300





LANSDALE ST

Summary

Parcel ID: 70265
Address: LANSDALE ST

Owner Information

Owner Name: MARY & K D'S DINER INC
Owner Address: 1203 PINEY FOREST RD
Mail-To: MARY & K D'S DINER INC
Mailing Address: 1203 PINEY FOREST RD, DANVILLE, VA 24540

Land Information

Flood Zones: N/A
Enterprise Zones: N/A
Historic Districts: N/A
Elementary School District: EA Gibson
Middle School District: O.T. Bonner

Value Information

Land Value: \$1,500
Land Use Value: N/A
Improvement: N/A
Total: \$1,500

Additional Information

State Code: 1091 Vac Res Lot Buildable - 1
Land Use: Residential
Tax Map: 1807003000012000
Approx. Acres: 0.1387
Legal Description: NO 21 SEC B LANSDALE ST
Zone: OTR Old Town Residential
Notes: DB 22-846: Affidavit with Merger from SCC attached, effective 3/1/18 & 30 lists. DB 05-5835: 17 lists.



Land

**Land area is based on information available, therefore acreage and/or square footage may be approximated.*

Land Code: Res Lots FV 1500

Rate: \$1,500

Acres/Units: N/A

Adj. Rate: \$1,500

Sq. Ft.: N/A

Base Value: N/A

Front: N/A

Adj. Amount: N/A

Effective Front: N/A

Value: \$1,500

Depth: N/A



Transfers

Deed:	Page:	Sale Date:	Sale Price:	Previous Owner:	Owner:
D 22	846	02/17/2022	N/A	DODSON GROUP INC	MARY & K D'S DINER INC
D 05	5835	11/18/2005	\$100,000	HOUSEMOVERS OF DANVILLE	DODSON GROUP INC
DP403	254	10/27/1960	N/A	N/A	N/A



Assessments

Year:	Land:	Use:	Improvements:	Total:
2023	\$1,500	N/A	N/A	\$1,500
2022	\$1,500	N/A	N/A	\$1,500
2021	\$1,500	N/A	N/A	\$1,500
2020	\$1,500	N/A	N/A	\$1,500
2019	\$1,500	N/A	N/A	\$1,500
2018	\$1,500	N/A	N/A	\$1,500
2017	\$1,500	N/A	N/A	\$1,500
2016	\$1,500	N/A	N/A	\$1,500
2015	\$1,500	N/A	N/A	\$1,500
2014	\$1,500	N/A	N/A	\$1,500
2013	\$1,500	N/A	N/A	\$1,500
2012	\$1,500	N/A	N/A	\$1,500
2011	\$1,500	N/A	N/A	\$1,500
2010	\$1,500	N/A	N/A	\$1,500
2009	\$1,500	N/A	N/A	\$1,500
2008	\$1,500	N/A	N/A	\$1,500
2007	\$1,500	N/A	N/A	\$1,500
2006	\$1,500	N/A	N/A	\$1,500
2005	\$1,500	N/A	N/A	\$1,500
2004	\$1,500	N/A	N/A	\$1,500
2003	\$1,500	N/A	N/A	\$1,500
2002	\$1,500	N/A	N/A	\$1,500
2001	\$1,500	N/A	N/A	\$1,500
2000	\$1,500	N/A	N/A	\$1,500





LANSDALE ST

Summary

Parcel ID: 70266
Address: LANSDALE ST

Owner Information

Owner Name: MARY & K D'S DINER INC
Owner Address: 1203 PINEY FOREST RD
Mail-To: MARY & K D'S DINER INC
Mailing Address: 1203 PINEY FOREST RD, DANVILLE, VA 24540

Land Information

Flood Zones: N/A
Enterprise Zones: N/A
Historic Districts: N/A
Elementary School District: EA Gibson
Middle School District: O.T. Bonner

Value Information

Land Value: \$1,500
Land Use Value: N/A
Improvement: N/A
Total: \$1,500

Additional Information

State Code: 1091 Vac Res Lot Buildable - 1
Land Use: Residential
Tax Map: 1807003000013000
Approx. Acres: 0.134
Legal Description: NO 22 SEC B LANSDALE ST
Zone: OTR Old Town Residential
Notes: DB 22-846: Affidavit with Merger from SCC attached, effective 3/1/18 & 30 lists. DB 05-5835: 17 lists.



Land

**Land area is based on information available, therefore acreage and/or square footage may be approximated.*

Land Code: Res Lots FV 1500

Rate: \$1,500

Acres/Units: N/A

Adj. Rate: \$1,500

Sq. Ft.: N/A

Base Value: N/A

Front: N/A

Adj. Amount: N/A

Effective Front: N/A

Value: \$1,500

Depth: N/A



Transfers

Deed:	Page:	Sale Date:	Sale Price:	Previous Owner:	Owner:
D 22	846	02/17/2022	N/A	DODSON GROUP INC	MARY & K D'S DINER INC
D 05	5835	11/18/2005	\$100,000	HOUSEMOVERS OF DANVILLE	DODSON GROUP INC
DP403	254	10/27/1960	N/A	N/A	N/A



Assessments

Year:	Land:	Use:	Improvements:	Total:
2023	\$1,500	N/A	N/A	\$1,500
2022	\$1,500	N/A	N/A	\$1,500
2021	\$1,500	N/A	N/A	\$1,500
2020	\$1,500	N/A	N/A	\$1,500
2019	\$1,500	N/A	N/A	\$1,500
2018	\$1,500	N/A	N/A	\$1,500
2017	\$1,500	N/A	N/A	\$1,500
2016	\$1,500	N/A	N/A	\$1,500
2015	\$1,500	N/A	N/A	\$1,500
2014	\$1,500	N/A	N/A	\$1,500
2013	\$1,500	N/A	N/A	\$1,500
2012	\$1,500	N/A	N/A	\$1,500
2011	\$1,500	N/A	N/A	\$1,500
2010	\$1,500	N/A	N/A	\$1,500
2009	\$1,500	N/A	N/A	\$1,500
2008	\$1,500	N/A	N/A	\$1,500
2007	\$1,500	N/A	N/A	\$1,500
2006	\$1,500	N/A	N/A	\$1,500
2005	\$1,500	N/A	N/A	\$1,500
2004	\$1,500	N/A	N/A	\$1,500
2003	\$1,500	N/A	N/A	\$1,500
2002	\$1,500	N/A	N/A	\$1,500
2001	\$1,500	N/A	N/A	\$1,500
2000	\$1,500	N/A	N/A	\$1,500

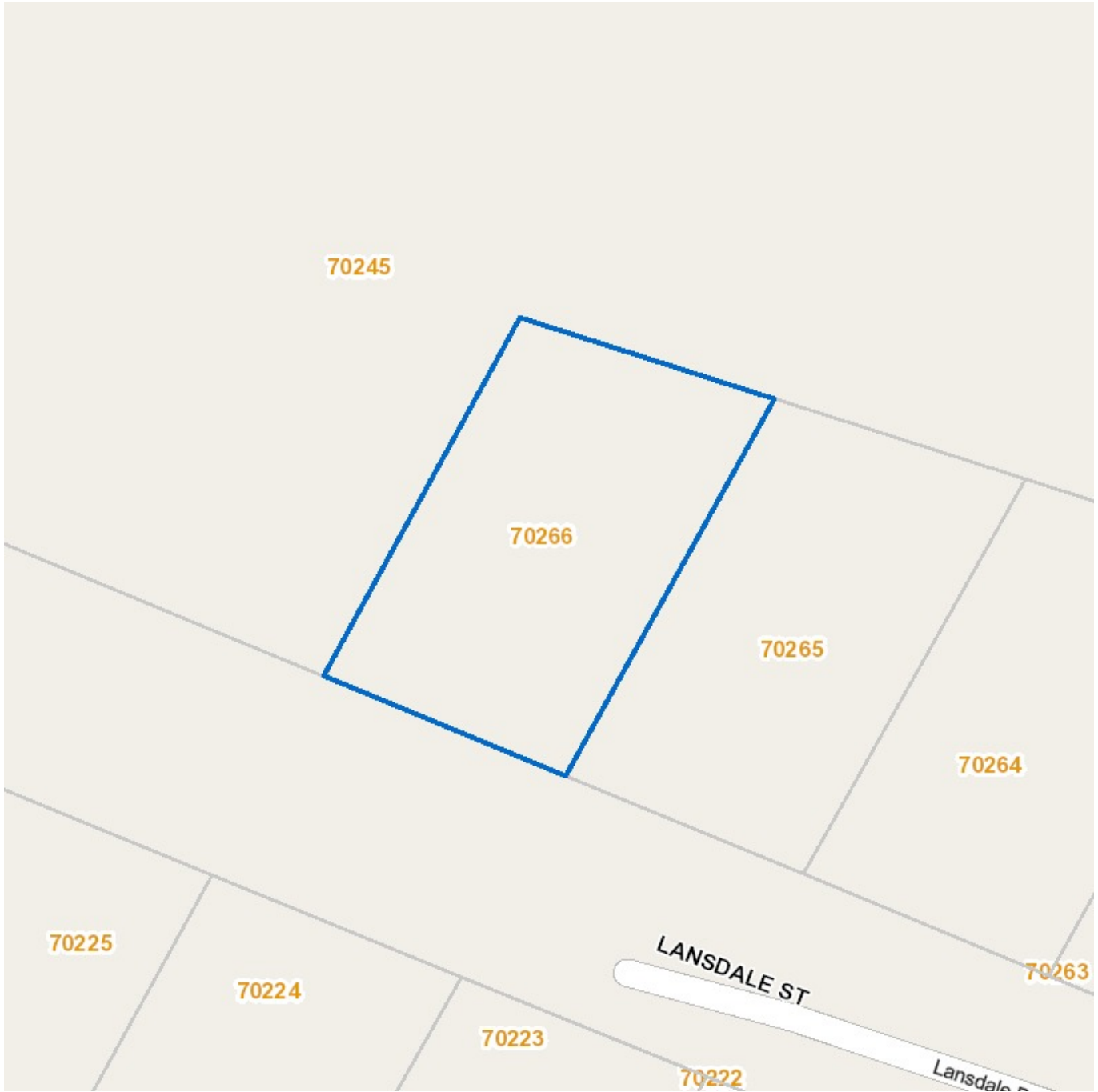



SYLVAN RD

Summary

Parcel ID: 78290
Address: SYLVAN RD

Owner Information

Owner Name: MARY & K D'S DINER INC
Owner Address: 1203 PINEY FOREST RD
Mail-To: MARY & K D'S DINER INC
Mailing Address: 1203 PINEY FOREST RD, DANVILLE, VA 24540

Land Information

Flood Zones: N/A
Enterprise Zones: N/A
Historic Districts: N/A

Elementary School District: EA Gibson

Middle School District: O.T. Bonner

Value Information

Land Value: \$1,300
Land Use Value: N/A
Improvement: N/A
Total: \$1,300

Additional Information

State Code: 1091 Vac Res Lot Buildable - 1
Land Use: Residential
Tax Map: 1807003000016000
Approx. Acres: 0.999
Legal Description: 1.058 AC TRACT 2 SEC A 211.93 FT SYLVAN RD
Zone: OTR Old Town Residential
Notes: DB 22-846: Affidavit with Merger from SCC attached, effective 3/1/18 & 30 lists. DB 05-5835 17 lists. Subdivide Info (DP 387-426) Conveyance (70245-387-426) Date of Sale (2/27/59) Transaction, Date (200401416, 2/9/04).



Land

**Land area is based on information available, therefore acreage and/or square footage may be approximated.*

Land Code: RA13 1200	Rate: \$1,200
Acres/Units: 1.06	Adj. Rate: \$1,200
Sq. Ft.: 46173.6	Base Value: \$1,270
Front: N/A	Adj. Amount: \$30
Effective Front: N/A	Value: \$1,300
Depth: N/A	



Transfers

Deed:	Page:	Sale Date:	Sale Price:	Previous Owner:	Owner:
D 22	846	02/17/2022	N/A	DODSON GROUP INC	MARY & K D'S DINER INC
D 05	5835	11/18/2005	\$100,000	HOUSEMOVERS OF DANVILLE	DODSON GROUP INC



Assessments

Year:	Land:	Use:	Improvements:	Total:
2023	\$1,300	N/A	N/A	\$1,300
2022	\$1,300	N/A	N/A	\$1,300
2021	\$1,300	N/A	N/A	\$1,300
2020	\$1,300	N/A	N/A	\$1,300
2019	\$1,300	N/A	N/A	\$1,300
2018	\$1,300	N/A	N/A	\$1,300
2017	\$1,300	N/A	N/A	\$1,300
2016	\$1,300	N/A	N/A	\$1,300
2015	\$1,300	N/A	N/A	\$1,300
2014	\$1,300	N/A	N/A	\$1,300
2013	\$1,300	N/A	N/A	\$1,300
2012	\$1,300	N/A	N/A	\$1,300
2011	\$1,300	N/A	N/A	\$1,300
2010	\$1,300	N/A	N/A	\$1,300
2009	\$1,300	N/A	N/A	\$1,300
2008	\$1,300	N/A	N/A	\$1,300
2007	\$1,300	N/A	N/A	\$1,300
2006	\$1,300	N/A	N/A	\$1,300
2005	\$1,200	N/A	N/A	\$1,200
2004	\$1,200	N/A	N/A	\$1,200

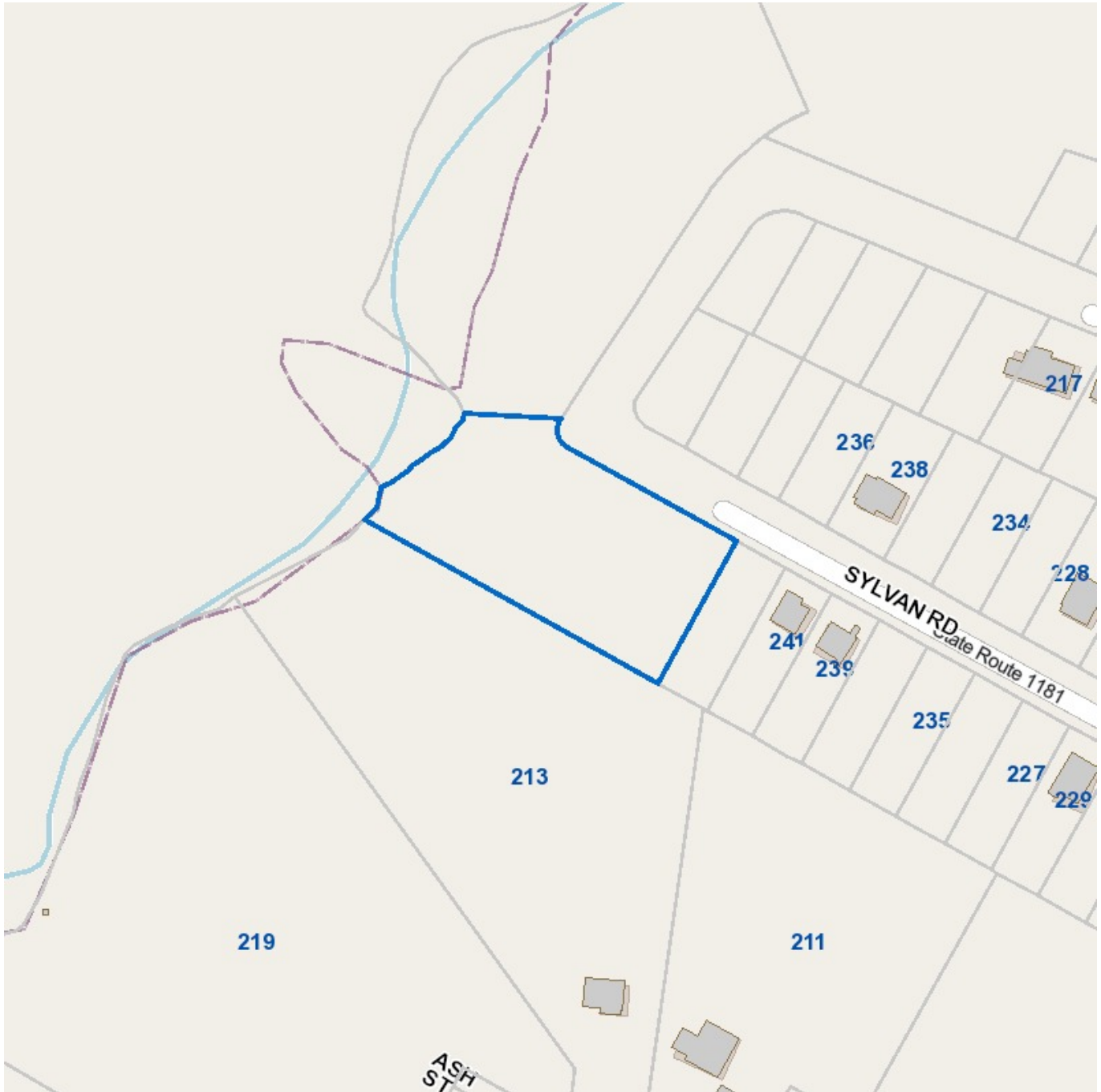

Offering #3: Tax Card

Address: TBD Wilborne Ave., TBD Nelson Ave., Danville, VA 24540

***Parcel ID 52138, 50617, 70282, 70281, 70280, 70287;
Consisting of +/- 13.82 acres and improvements***



VAAuctionPro.com



**Blue Ridge Land
& Auction Co., Inc**

Matt Gallimore, Broker/Auctioneer



WILBORNE AVE

Summary

Parcel ID: 50617
Address: WILBORNE AVE

Owner Information

Owner Name: MARY & K D'S DINER INC
Owner Address: 1203 PINEY FOREST RD
Mail-To: MARY & K D'S DINER INC
Mailing Address: 1203 PINEY FOREST RD, DANVILLE, VA 24540

Land Information

Flood Zones: N/A
Enterprise Zones: N/A
Historic Districts: N/A
Elementary School District: EA Gibson
Middle School District: O.T. Bonner

Value Information

Land Value: \$151,400
Land Use Value: N/A
Improvement: N/A
Total: \$151,400

Additional Information

State Code: 1091 Vac Res Lot Buildable - 1
Land Use: Residential
Tax Map: 1808011000030000
Approx. Acres: 12.46
Legal Description: 12.62 AC NO 15A WILBORNE AVE
Zone: MR Multi-Family Residential
Notes: DB 22-846: Affidavit with Merger from SCC attached, effective 3/1/18 & 30 lists. DB 06-617: 5 lists.



Land

**Land area is based on information available, therefore acreage and/or square footage may be approximated.*

Land Code: RA34 12000	Rate: \$12,000
Acres/Units: 12.62	Adj. Rate: \$12,000
Sq. Ft.: 549727.2	Base Value: \$151,440
Front: N/A	Adj. Amount: \$-40
Effective Front: N/A	Value: \$151,400
Depth: N/A	



Transfers

Deed:	Page:	Sale Date:	Sale Price:	Previous Owner:	Owner:
D 22	846	02/17/2022	N/A	DODSON GROUP INC	MARY & K D'S DINER INC
D 06	617	02/08/2006	N/A	FARLOW JR JAMES M	DODSON GROUP INC
D 912	679	02/28/1994	N/A	N/A	N/A



Assessments

Year:	Land:	Use:	Improvements:	Total:
2023	\$151,400	N/A	N/A	\$151,400
2022	\$151,400	N/A	N/A	\$151,400
2021	\$151,400	N/A	N/A	\$151,400
2020	\$151,400	N/A	N/A	\$151,400
2019	\$151,400	N/A	N/A	\$151,400
2018	\$151,400	N/A	N/A	\$151,400
2017	\$151,400	N/A	N/A	\$151,400
2016	\$151,400	N/A	N/A	\$151,400
2015	\$151,400	N/A	N/A	\$151,400
2014	\$151,400	N/A	N/A	\$151,400
2013	\$151,400	N/A	N/A	\$151,400
2012	\$151,400	N/A	N/A	\$151,400
2011	\$151,400	N/A	N/A	\$151,400
2010	\$151,400	N/A	N/A	\$151,400
2009	\$151,400	N/A	N/A	\$151,400
2008	\$151,400	N/A	N/A	\$151,400
2007	\$151,400	N/A	N/A	\$151,400
2006	\$151,400	N/A	N/A	\$151,400
2005	\$44,000	N/A	N/A	\$44,000
2004	\$44,000	N/A	N/A	\$44,000
2003	\$44,000	N/A	N/A	\$44,000
2002	\$44,000	N/A	N/A	\$44,000
2001	\$44,000	N/A	N/A	\$44,000
2000	\$44,000	N/A	N/A	\$44,000

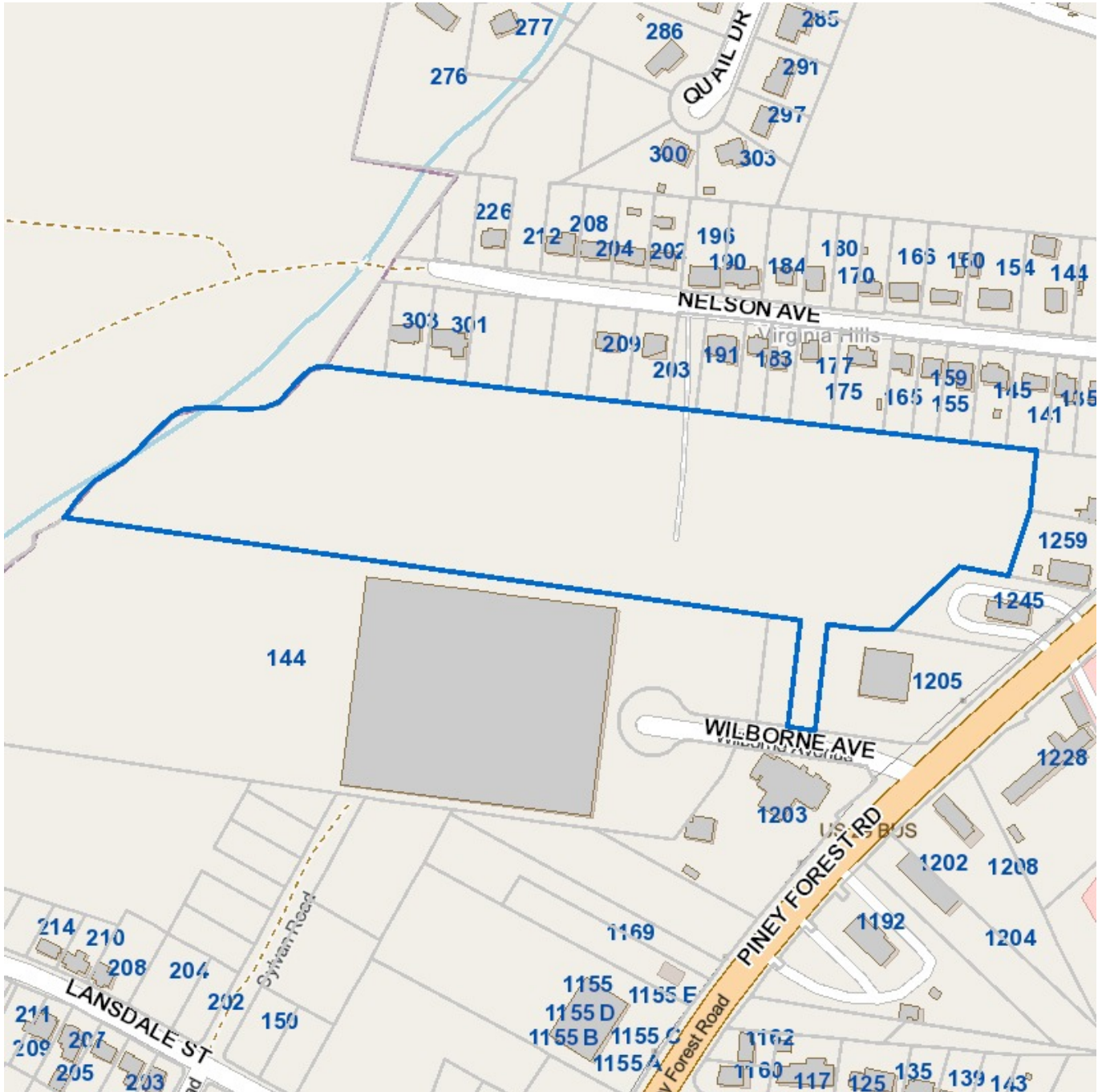



WILBORNE AVE

Summary

Parcel ID: 52138
Address: WILBORNE AVE

Owner Information

Owner Name: MARY & K D'S DINER INC
Owner Address: 1203 PINEY FOREST RD
Mail-To: MARY & K D'S DINER INC
Mailing Address: 1203 PINEY FOREST RD, DANVILLE, VA 24540

Land Information

Flood Zones: N/A
Enterprise Zones: N/A
Historic Districts: N/A

Elementary School District: EA Gibson

Middle School District: O.T. Bonner

Value Information

Land Value: \$37,300
Land Use Value: N/A
Improvement: N/A
Total: \$37,300

Additional Information

State Code: 1091 Vac Res Lot Buildable - 1
Land Use: Residential
Tax Map: 1808011000031000
Approx. Acres: 0.2716
Legal Description: 60 FT NO 14 WILBORNE AVE
Zone: MR Multi-Family Residential
Notes: Avg Lot: 60.0 X 198.0 DB 22-846: Affidavit with Merger from SCC attached, effective 3/1/18 & 30 lists. DB 06-617: 5 lists.



Land

**Land area is based on information available, therefore acreage and/or square footage may be approximated.*

Land Code: Res FF (700)

Acres/Units: 0.27

Sq. Ft.: 11761.2

Front: N/A

Effective Front: 60

Depth: 198

Rate: \$700

Adj. Rate: \$777

Base Value: \$46,620

Adj. Amount: \$-9,320

Value: \$37,300



Transfers

Deed:	Page:	Sale Date:	Sale Price:	Previous Owner:	Owner:
D 22	846	02/17/2022	N/A	DODSON GROUP INC	MARY & K D'S DINER INC
D 06	617	02/08/2006	N/A	FARLOW JR JAMES M	DODSON GROUP INC
D 912	679	02/28/1994	N/A	N/A	N/A



Assessments

Year:	Land:	Use:	Improvements:	Total:
2023	\$37,300	N/A	N/A	\$37,300
2022	\$37,300	N/A	N/A	\$37,300
2021	\$37,300	N/A	N/A	\$37,300
2020	\$37,300	N/A	N/A	\$37,300
2019	\$37,300	N/A	N/A	\$37,300
2018	\$37,300	N/A	N/A	\$37,300
2017	\$37,300	N/A	N/A	\$37,300
2016	\$37,300	N/A	N/A	\$37,300
2015	\$37,300	N/A	N/A	\$37,300
2014	\$37,300	N/A	N/A	\$37,300
2013	\$37,300	N/A	N/A	\$37,300
2012	\$37,300	N/A	N/A	\$37,300
2011	\$37,300	N/A	N/A	\$37,300
2010	\$37,300	N/A	N/A	\$37,300
2009	\$37,300	N/A	N/A	\$37,300
2008	\$37,300	N/A	N/A	\$37,300
2007	\$37,300	N/A	N/A	\$37,300
2006	\$37,300	N/A	N/A	\$37,300
2005	\$37,300	N/A	N/A	\$37,300
2004	\$37,300	N/A	N/A	\$37,300
2003	\$37,300	N/A	N/A	\$37,300
2002	\$37,300	N/A	N/A	\$37,300
2001	\$21,300	N/A	N/A	\$21,300
2000	\$21,300	N/A	N/A	\$21,300





NELSON AVE

Summary

Parcel ID: 70280
Address: NELSON AVE

Owner Information

Owner Name: MARY & K D'S DINER INC
Owner Address: 1203 PINEY FOREST RD
Mail-To: MARY & K D'S DINER INC
Mailing Address: 1203 PINEY FOREST RD, DANVILLE, VA 24540

Land Information

Flood Zones: N/A
Enterprise Zones: N/A
Historic Districts: N/A

Elementary School District: EA Gibson

Middle School District: O.T. Bonner

Value Information

Land Value: \$500
Land Use Value: N/A
Improvement: N/A
Total: \$500

Additional Information

State Code: 1091 Vac Res Lot Buildable - 1
Land Use: Residential
Tax Map: 1808011000006000
Approx. Acres: 0.2989
Legal Description: NO 11 (.29 AC) NELSON AVE
Zone: OTR Old Town Residential
Notes: DB 22-846: Affidavit with Merger from SCC attached, effective 3/1/18 & 30 lists. DB 06-3758: 3 lists incl acct#70280, 70281 & 70282.



Land

**Land area is based on information available, therefore acreage and/or square footage may be approximated.*

Land Code: Res Lots FV 500	Rate: \$500
Acres/Units: N/A	Adj. Rate: \$500
Sq. Ft.: N/A	Base Value: N/A
Front: N/A	Adj. Amount: N/A
Effective Front: N/A	Value: \$500
Depth: N/A	



Transfers

Deed:	Page:	Sale Date:	Sale Price:	Previous Owner:	Owner:
D 22	846	02/17/2022	N/A	DODSON GROUP INC	MARY & K D'S DINER INC
D 06	3758	08/09/2006	N/A	S & Z REALTY CO	DODSON GROUP INC
DP425	511	N/A	\$4,800	N/A	S & Z REALTY CO



Assessments

Year:	Land:	Use:	Improvements:	Total:
2023	\$500	N/A	N/A	\$500
2022	\$500	N/A	N/A	\$500
2021	\$500	N/A	N/A	\$500
2020	\$500	N/A	N/A	\$500
2019	\$500	N/A	N/A	\$500
2018	\$500	N/A	N/A	\$500
2017	\$500	N/A	N/A	\$500
2016	\$500	N/A	N/A	\$500
2015	\$500	N/A	N/A	\$500
2014	\$500	N/A	N/A	\$500
2013	\$500	N/A	N/A	\$500
2012	\$500	N/A	N/A	\$500
2011	\$500	N/A	N/A	\$500
2010	\$500	N/A	N/A	\$500
2009	\$500	N/A	N/A	\$500
2008	\$500	N/A	N/A	\$500
2007	\$500	N/A	N/A	\$500
2006	\$500	N/A	N/A	\$500
2005	\$500	N/A	N/A	\$500
2004	\$500	N/A	N/A	\$500
2003	\$500	N/A	N/A	\$500
2002	\$500	N/A	N/A	\$500
2001	\$500	N/A	N/A	\$500
2000	\$500	N/A	N/A	\$500





NELSON AVE

Summary

Parcel ID: 70281

Address: NELSON AVE

Owner Information

Owner Name: MARY & K D'S DINER INC

Owner Address: 1203 PINEY FOREST RD

Mail-To: MARY & K D'S DINER INC

Mailing Address: 1203 PINEY FOREST RD, DANVILLE, VA
24540

Land Information

Flood Zones: N/A

Enterprise Zones: N/A

Historic Districts: N/A

Elementary School District: EA Gibson

Middle School District: O.T. Bonner

Value Information

Land Value: \$500

Land Use Value: N/A

Improvement: N/A

Total: \$500

Additional Information

State Code: 1091 Vac Res Lot Buildable - 1

Land Use: Residential

Tax Map: 1808011000005000

Approx. Acres: 0.2895

Legal Description: NO 12 (.29 AC) NELSON AVE

Zone: OTR Old Town Residential

Notes: DB 22-846: Affidavit with Merger from SCC attached, effective 3/1/18 & 30 lists. DB 06-3758: 3 lists incl acct# 70280, 70281 & 70282.



Land

**Land area is based on information available, therefore acreage and/or square footage may be approximated.*

Land Code: Res Lots FV 500	Rate: \$500
Acres/Units: N/A	Adj. Rate: \$500
Sq. Ft.: N/A	Base Value: N/A
Front: N/A	Adj. Amount: N/A
Effective Front: N/A	Value: \$500
Depth: N/A	



Transfers

Deed:	Page:	Sale Date:	Sale Price:	Previous Owner:	Owner:
D 22	846	02/17/2022	N/A	DODSON GROUP INC	MARY & K D'S DINER INC
D 06	3758	08/09/2006	N/A	S & Z REALTY CO	DODSON GROUP INC
DP425	511	N/A	N/A	N/A	N/A



Assessments

Year:	Land:	Use:	Improvements:	Total:
2023	\$500	N/A	N/A	\$500
2022	\$500	N/A	N/A	\$500
2021	\$500	N/A	N/A	\$500
2020	\$500	N/A	N/A	\$500
2019	\$500	N/A	N/A	\$500
2018	\$500	N/A	N/A	\$500
2017	\$500	N/A	N/A	\$500
2016	\$500	N/A	N/A	\$500
2015	\$500	N/A	N/A	\$500
2014	\$500	N/A	N/A	\$500
2013	\$500	N/A	N/A	\$500
2012	\$500	N/A	N/A	\$500
2011	\$500	N/A	N/A	\$500
2010	\$500	N/A	N/A	\$500
2009	\$500	N/A	N/A	\$500
2008	\$500	N/A	N/A	\$500
2007	\$500	N/A	N/A	\$500
2006	\$500	N/A	N/A	\$500
2005	\$500	N/A	N/A	\$500
2004	\$500	N/A	N/A	\$500
2003	\$500	N/A	N/A	\$500
2002	\$500	N/A	N/A	\$500
2001	\$500	N/A	N/A	\$500
2000	\$500	N/A	N/A	\$500





NELSON AVE

Summary

Parcel ID: 70282
Address: NELSON AVE

Owner Information

Owner Name: MARY & K D'S DINER INC
Owner Address: 1203 PINEY FOREST RD
Mail-To: MARY & K D'S DINER INC
Mailing Address: 1203 PINEY FOREST RD, DANVILLE, VA 24540

Land Information

Flood Zones: N/A
Enterprise Zones: N/A
Historic Districts: N/A

Elementary School District: EA Gibson

Middle School District: O.T. Bonner

Value Information

Land Value: \$500
Land Use Value: N/A
Improvement: N/A
Total: \$500

Additional Information

State Code: 1091 Vac Res Lot Buildable - 1
Land Use: Residential
Tax Map: 1808011000004000
Approx. Acres: 0.2928
Legal Description: NO 13 (.29 AC) NELSON AVE
Zone: OTR Old Town Residential
Notes: DB 22-846: Affidavit with Merger from SCC attached, effective 3/1/18 & 30 lists. DB 06-3758: 3 lists incl acct# 70280, 70281 & 70282.



Land

**Land area is based on information available, therefore acreage and/or square footage may be approximated.*

Land Code: Res Lots FV 500	Rate: \$500
Acres/Units: N/A	Adj. Rate: \$500
Sq. Ft.: N/A	Base Value: N/A
Front: N/A	Adj. Amount: N/A
Effective Front: N/A	Value: \$500
Depth: N/A	



Transfers

Deed:	Page:	Sale Date:	Sale Price:	Previous Owner:	Owner:
D 22	846	02/17/2022	N/A	DODSON GROUP INC	MARY & K D'S DINER INC
D 06	3758	08/09/2006	N/A	S & Z REALTY CO	DODSON GROUP INC
DP425	511	N/A	N/A	N/A	N/A



Assessments

Year:	Land:	Use:	Improvements:	Total:
2023	\$500	N/A	N/A	\$500
2022	\$500	N/A	N/A	\$500
2021	\$500	N/A	N/A	\$500
2020	\$500	N/A	N/A	\$500
2019	\$500	N/A	N/A	\$500
2018	\$500	N/A	N/A	\$500
2017	\$500	N/A	N/A	\$500
2016	\$500	N/A	N/A	\$500
2015	\$500	N/A	N/A	\$500
2014	\$500	N/A	N/A	\$500
2013	\$500	N/A	N/A	\$500
2012	\$500	N/A	N/A	\$500
2011	\$500	N/A	N/A	\$500
2010	\$500	N/A	N/A	\$500
2009	\$500	N/A	N/A	\$500
2008	\$500	N/A	N/A	\$500
2007	\$500	N/A	N/A	\$500
2006	\$500	N/A	N/A	\$500
2005	\$500	N/A	N/A	\$500
2004	\$500	N/A	N/A	\$500
2003	\$500	N/A	N/A	\$500
2002	\$500	N/A	N/A	\$500
2001	\$500	N/A	N/A	\$500
2000	\$500	N/A	N/A	\$500

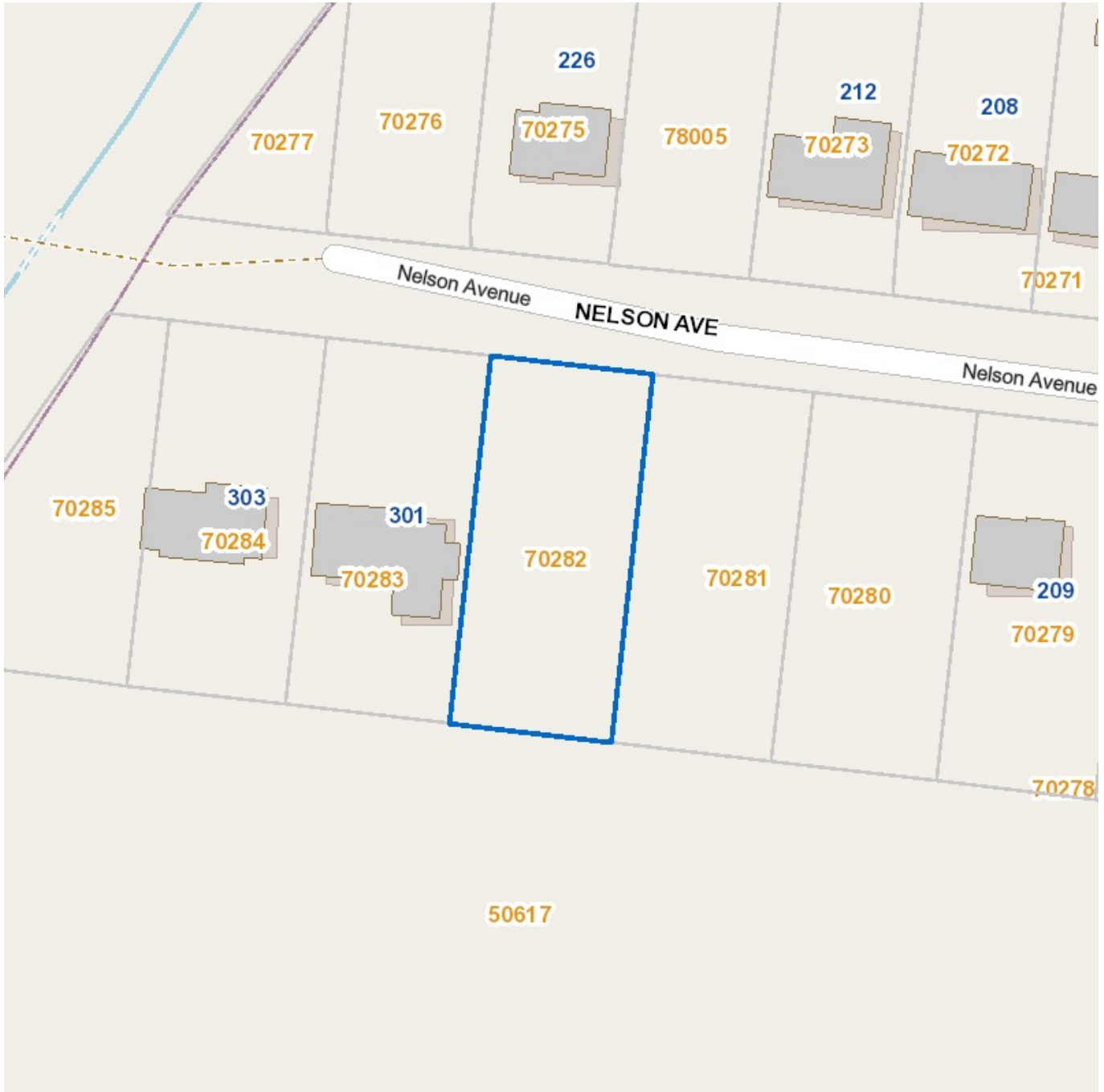



NELSON AVE

Summary

Parcel ID: 70287
Address: NELSON AVE

Owner Information

Owner Name: MARY & K D'S DINER INC
Owner Address: 1203 PINEY FOREST RD
Mail-To: MARY & K D'S DINER INC
Mailing Address: 1203 PINEY FOREST RD, DANVILLE, VA 24540

Land Information

Flood Zones: N/A
Enterprise Zones: N/A
Historic Districts: N/A
Elementary School District: EA Gibson
Middle School District: O.T. Bonner

Value Information

Land Value: \$2,500
Land Use Value: N/A
Improvement: N/A
Total: \$2,500

Additional Information

State Code: 1091 Vac Res Lot Buildable - 1
Land Use: Residential
Tax Map: 1808011000009000
Approx. Acres: 0.2091
Legal Description: NO 97-98 (.20 AC) NELSON AVE
Zone: OTR Old Town Residential
Notes: DB 22-846: Affidavit with Merger from SCC attached, effective 3/1/18 & 30 lists. DB 06-617: 5 lists.



Land

**Land area is based on information available, therefore acreage and/or square footage may be approximated.*

Land Code: Res Lots FV 2500

Rate: \$2,500

Acres/Units: N/A

Adj. Rate: \$2,500

Sq. Ft.: N/A

Base Value: N/A

Front: N/A

Adj. Amount: N/A

Effective Front: N/A

Value: \$2,500

Depth: N/A



Transfers

Deed:	Page:	Sale Date:	Sale Price:	Previous Owner:	Owner:
D 22	846	02/17/2022	N/A	DODSON GROUP INC	MARY & K D'S DINER INC
D 06	617	02/08/2006	N/A	FARLOW JR JAMES M	DODSON GROUP INC
D 912	679	02/28/1994	N/A	N/A	N/A



Assessments

Year:	Land:	Use:	Improvements:	Total:
2023	\$2,500	N/A	N/A	\$2,500
2022	\$2,500	N/A	N/A	\$2,500
2021	\$2,500	N/A	N/A	\$2,500
2020	\$2,500	N/A	N/A	\$2,500
2019	\$2,500	N/A	N/A	\$2,500
2018	\$2,500	N/A	N/A	\$2,500
2017	\$2,500	N/A	N/A	\$2,500
2016	\$2,500	N/A	N/A	\$2,500
2015	\$2,500	N/A	N/A	\$2,500
2014	\$2,500	N/A	N/A	\$2,500
2013	\$2,500	N/A	N/A	\$2,500
2012	\$2,500	N/A	N/A	\$2,500
2011	\$2,500	N/A	N/A	\$2,500
2010	\$2,500	N/A	N/A	\$2,500
2009	\$2,500	N/A	N/A	\$2,500
2008	\$2,500	N/A	N/A	\$2,500
2007	\$2,500	N/A	N/A	\$2,500
2006	\$2,500	N/A	N/A	\$2,500
2005	\$2,500	N/A	N/A	\$2,500
2004	\$2,500	N/A	N/A	\$2,500
2003	\$2,500	N/A	N/A	\$2,500
2002	\$2,500	N/A	N/A	\$2,500
2001	\$2,500	N/A	N/A	\$2,500
2000	\$2,500	N/A	N/A	\$2,500

